

UF-642

SW Campus Transportation Improvements

Advanced Schematic Design Approval

LVL Committee Presentation

December 12, 2019

Stuart Cullen, Sr. Project Manager

UF Planning Design & Construction

Jay Brown, PE / C. Elisabeth Manley, PLA

JBrown Professional Group / Manley Design

SW Campus Transportation Improvements

- Location
- Background
- Status & Schedule

SW Campus Transportation Improvements

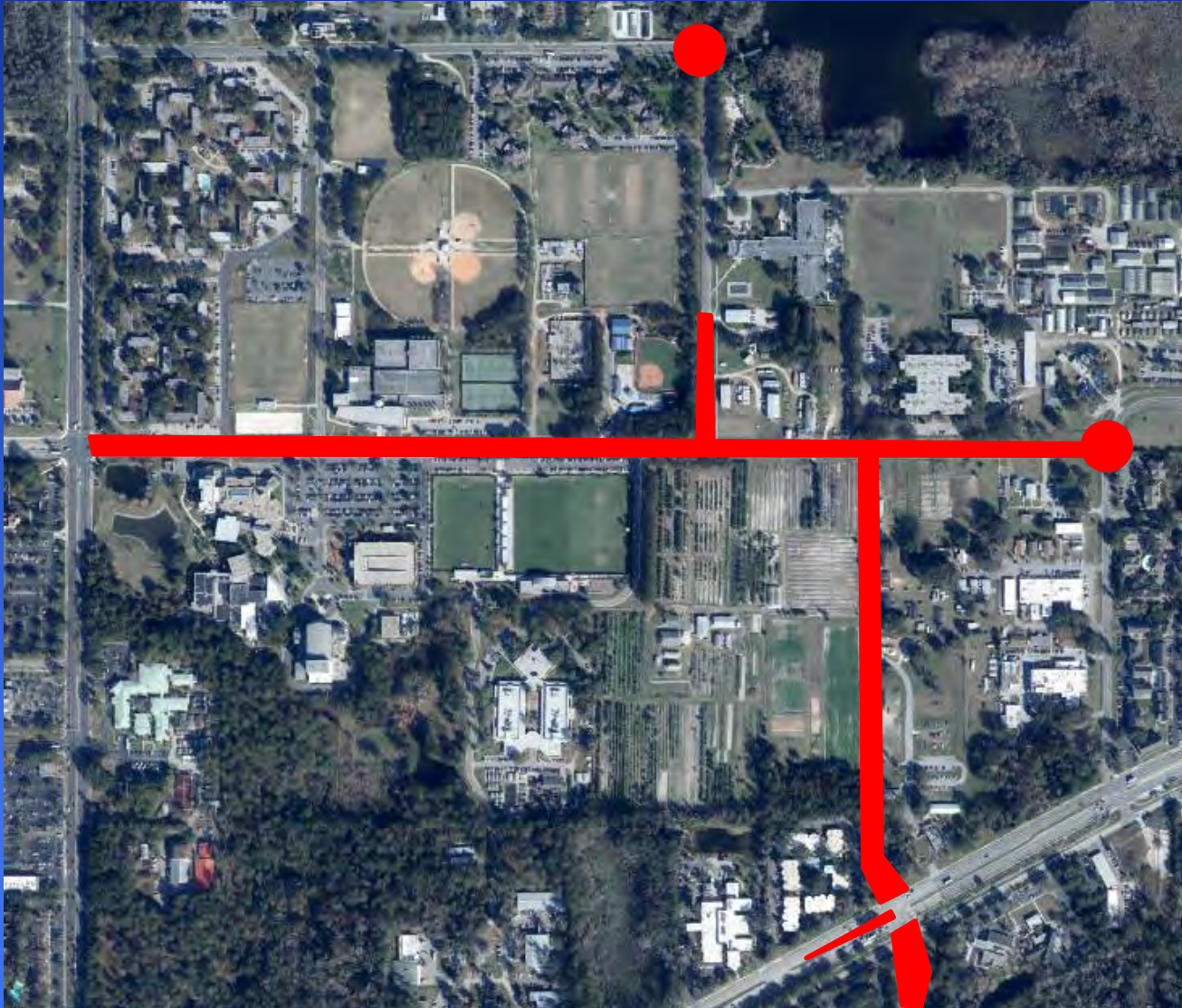

SW Campus Transportation Improvements

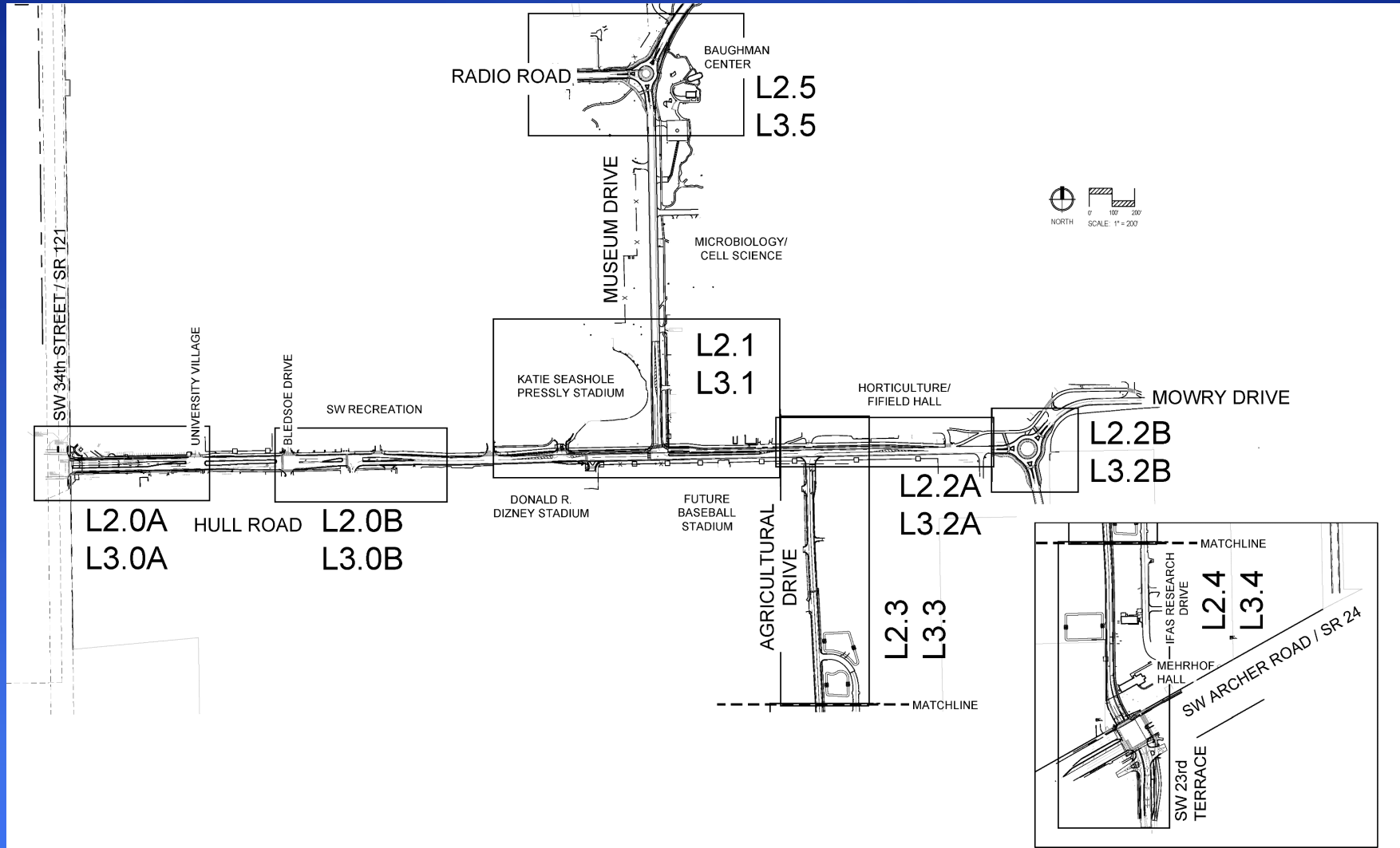

SW Campus Transportation Improvements

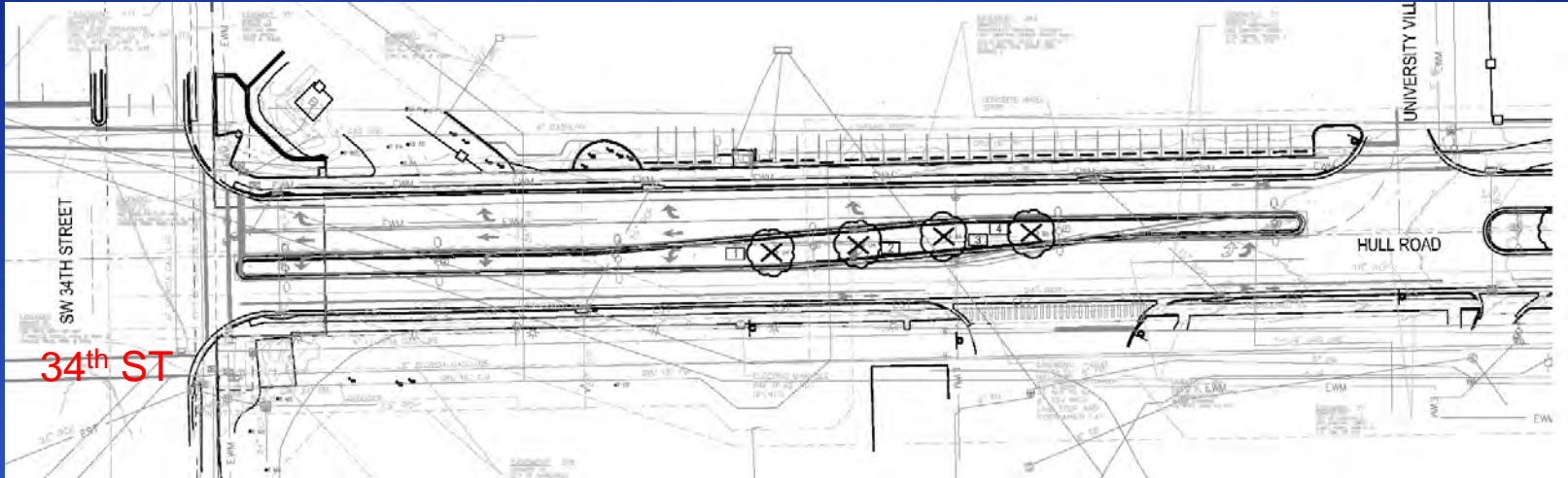

Impact

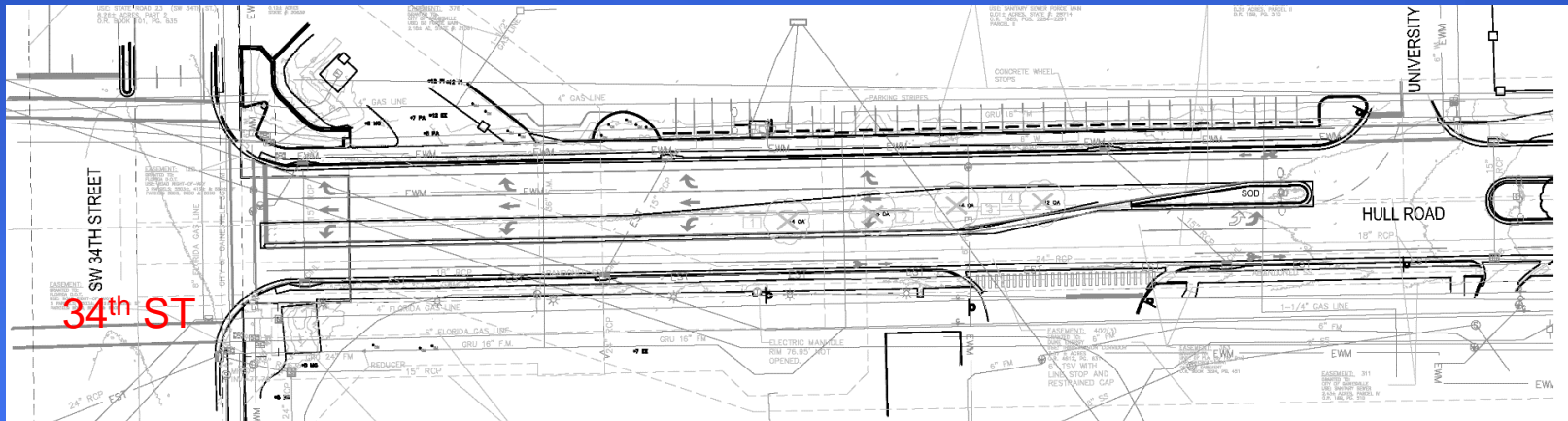

Proposed

SW Campus Transportation Improvements

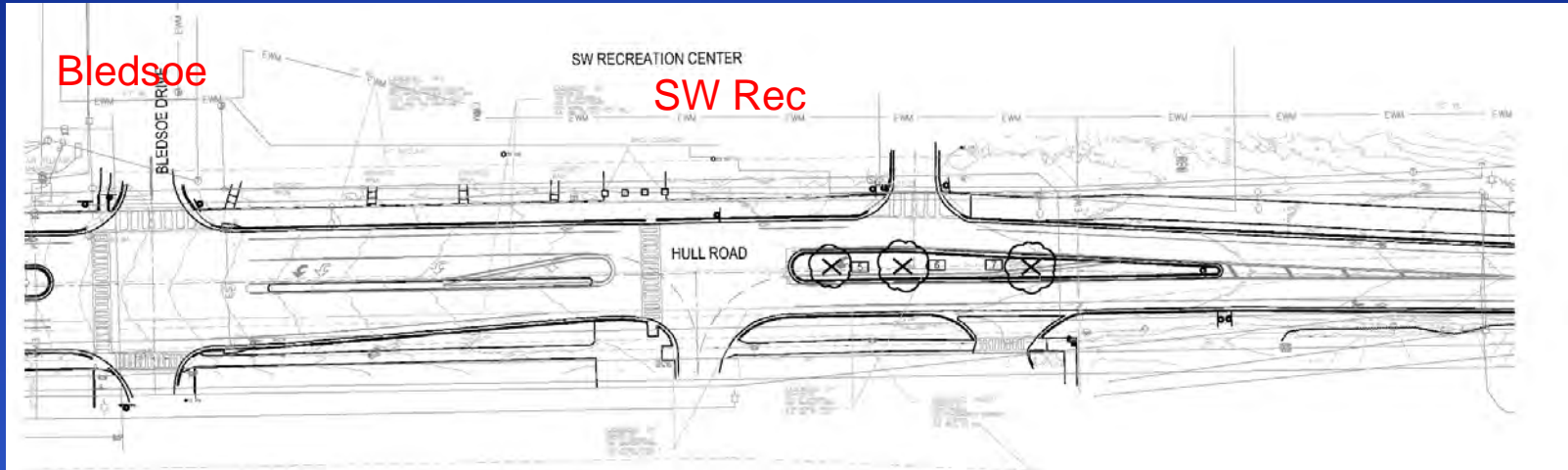

Impact

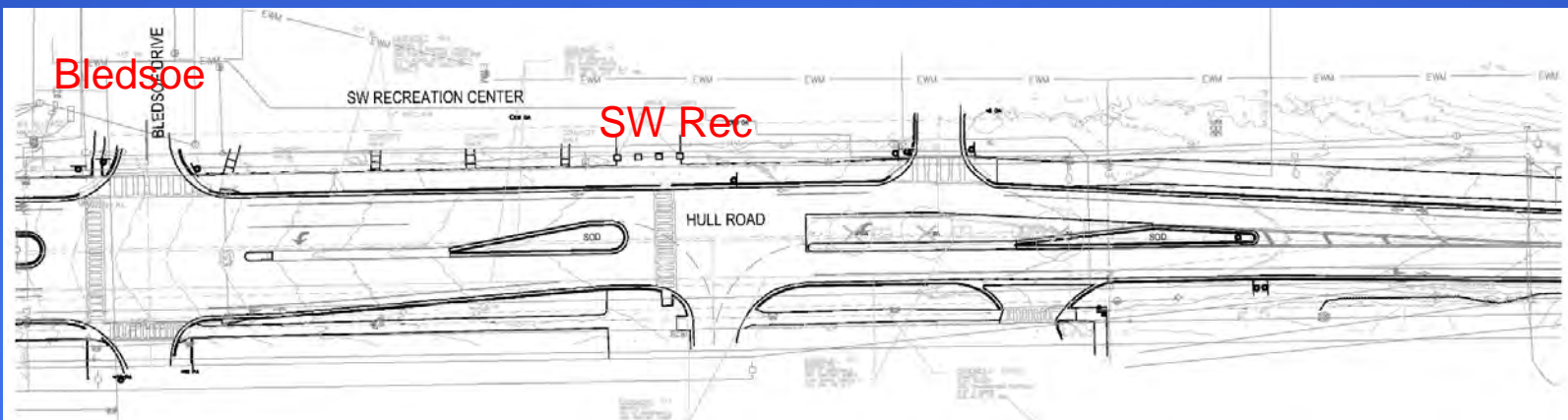

Proposed

Impact

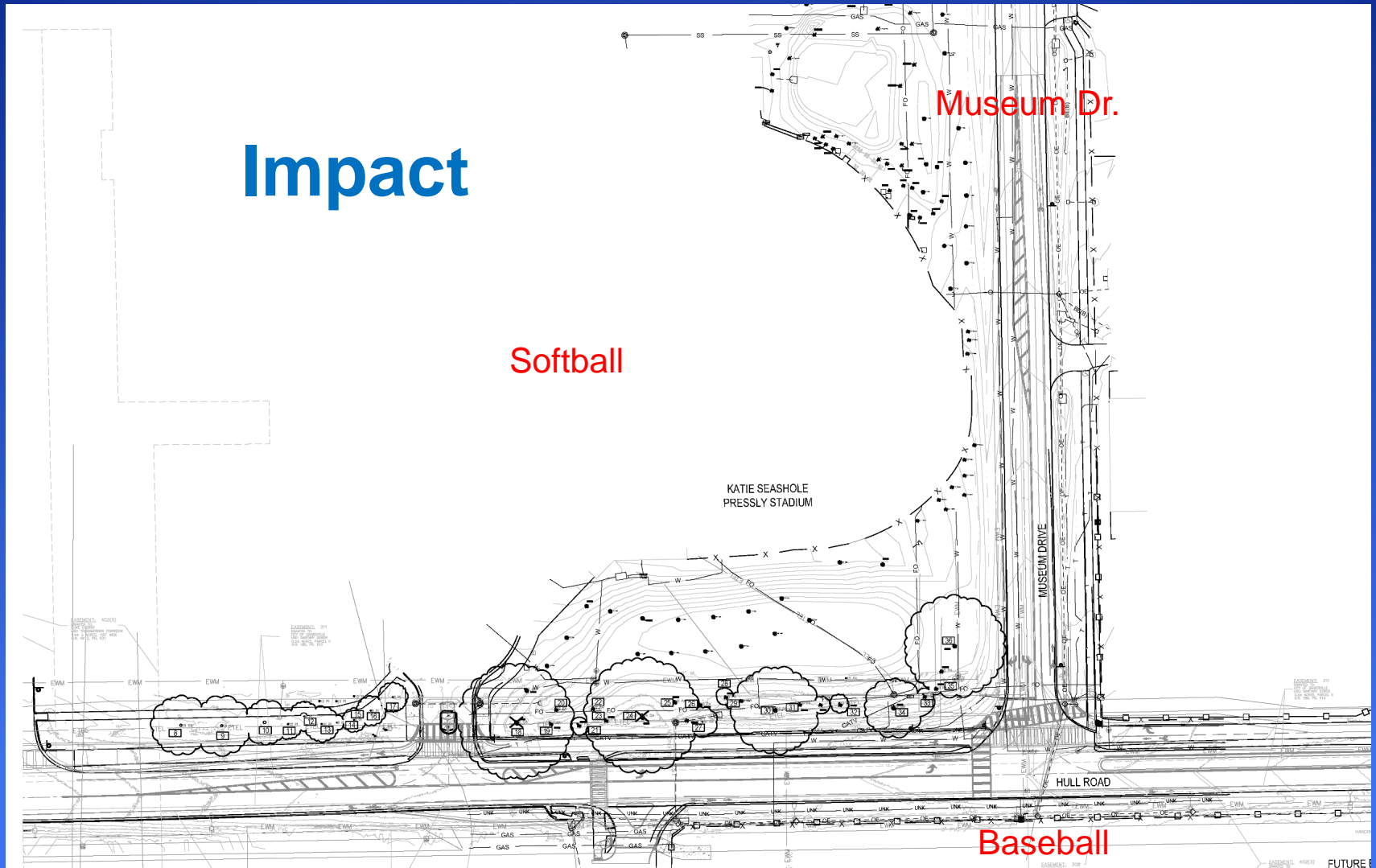

SW Campus Transportation Improvements

Proposed

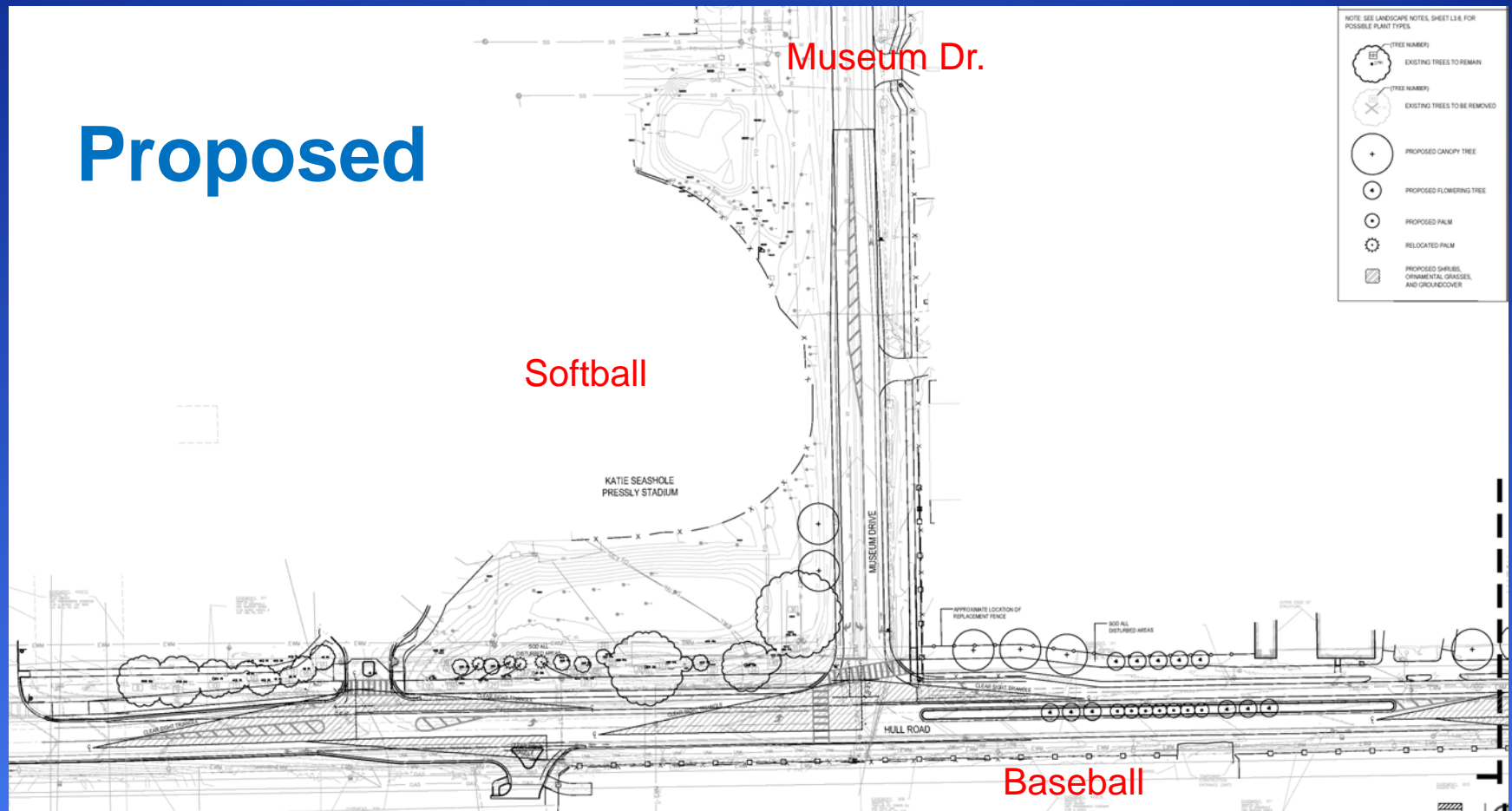

SW Campus Transportation Improvements

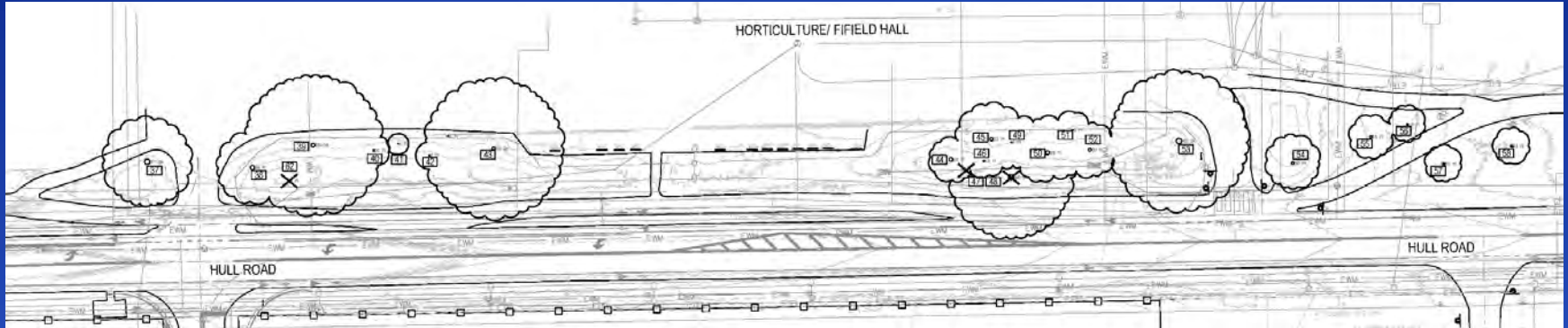

Impact

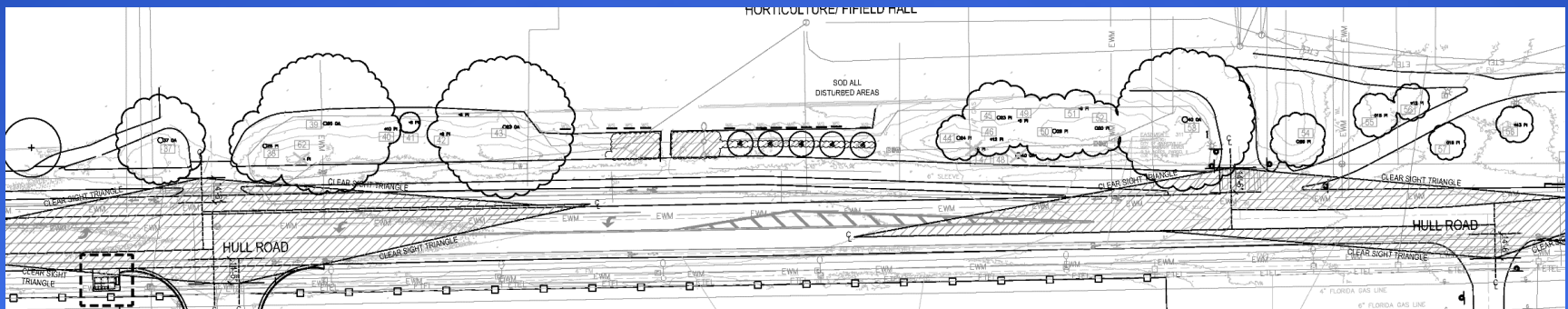

Proposed

SW Campus Transportation Improvements

Impact

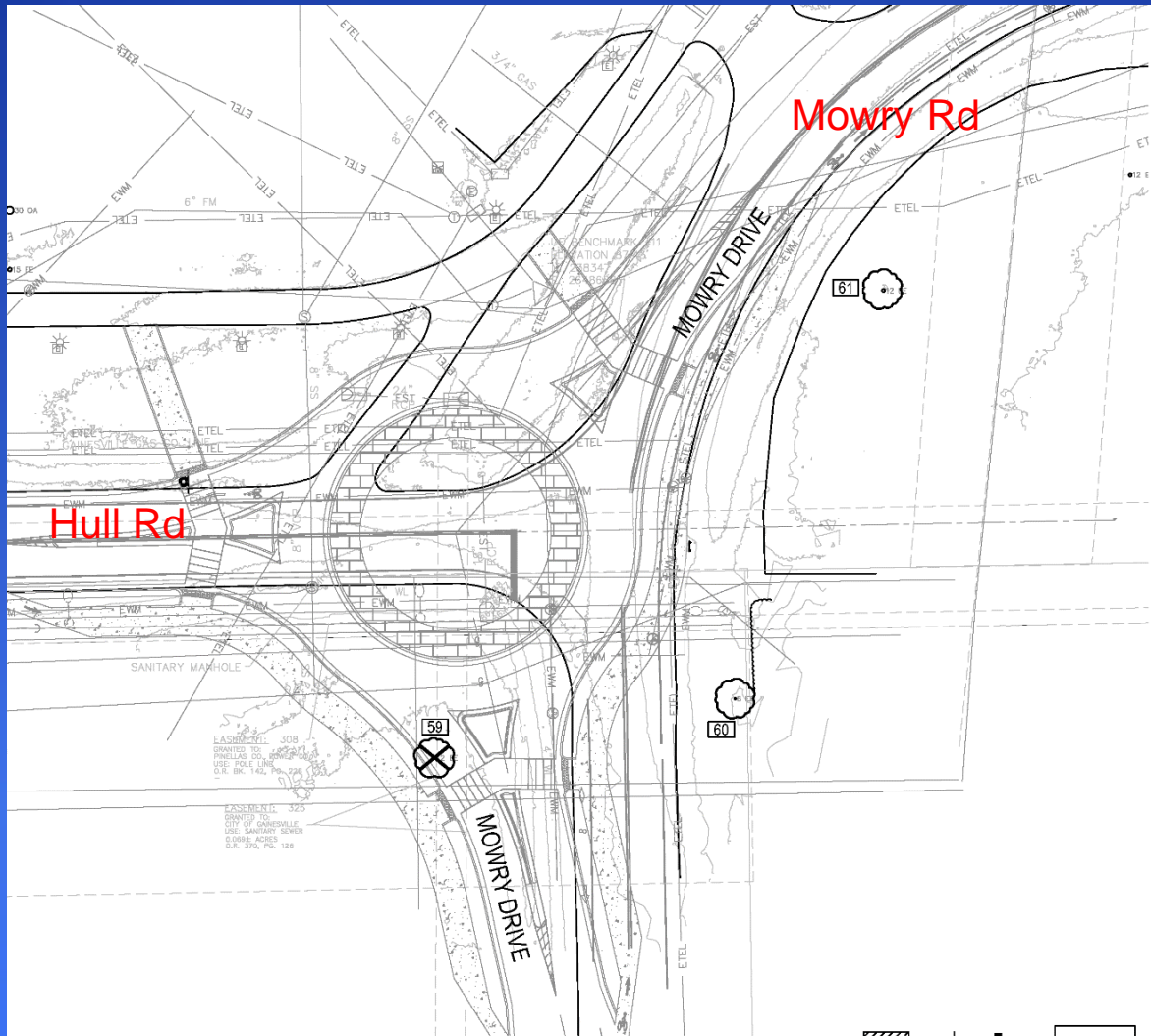

SW Campus Transportation Improvements

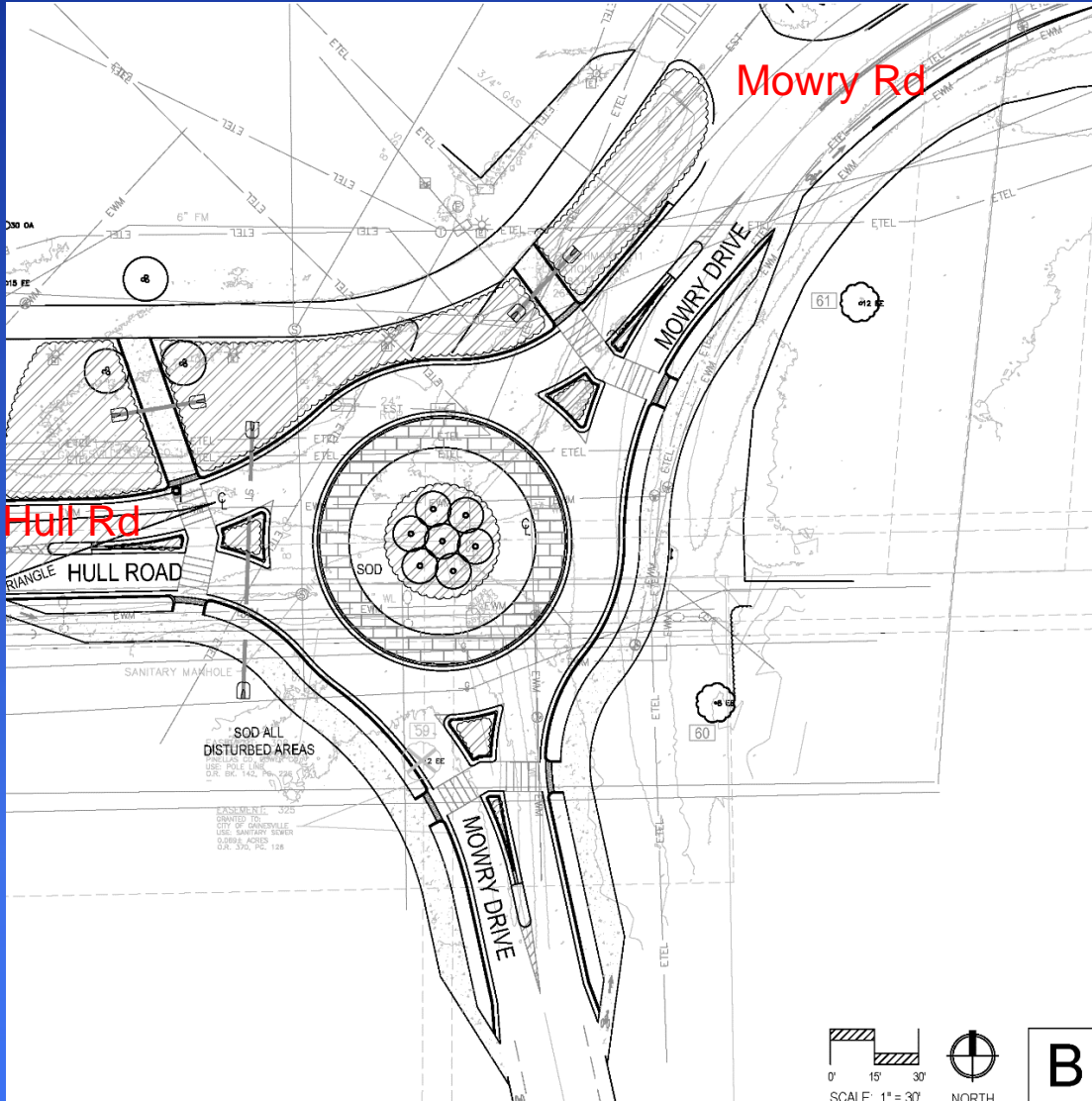

Proposed

SW Campus Transportation Improvements

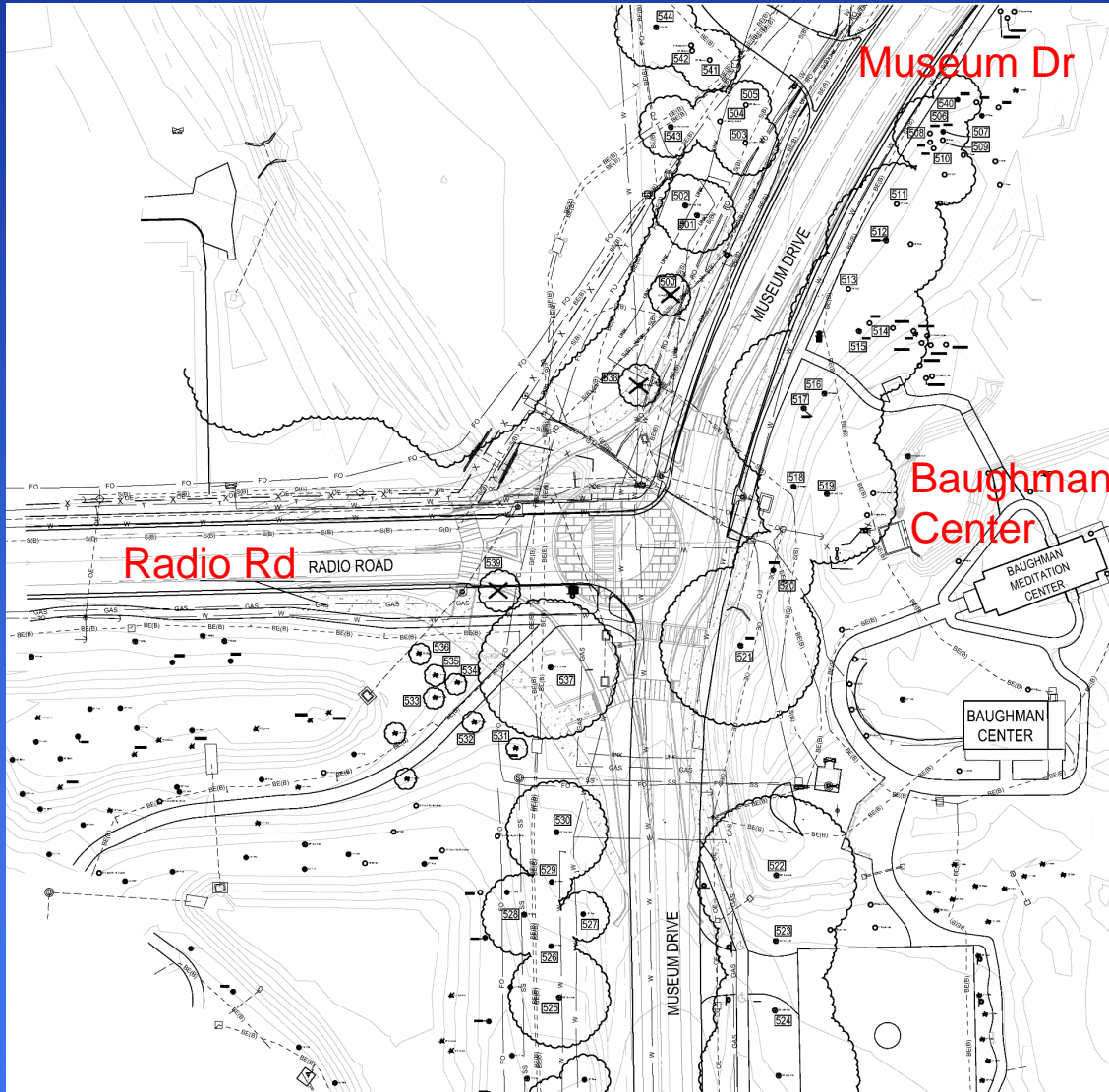

Impact

SW Campus Transportation Improvements

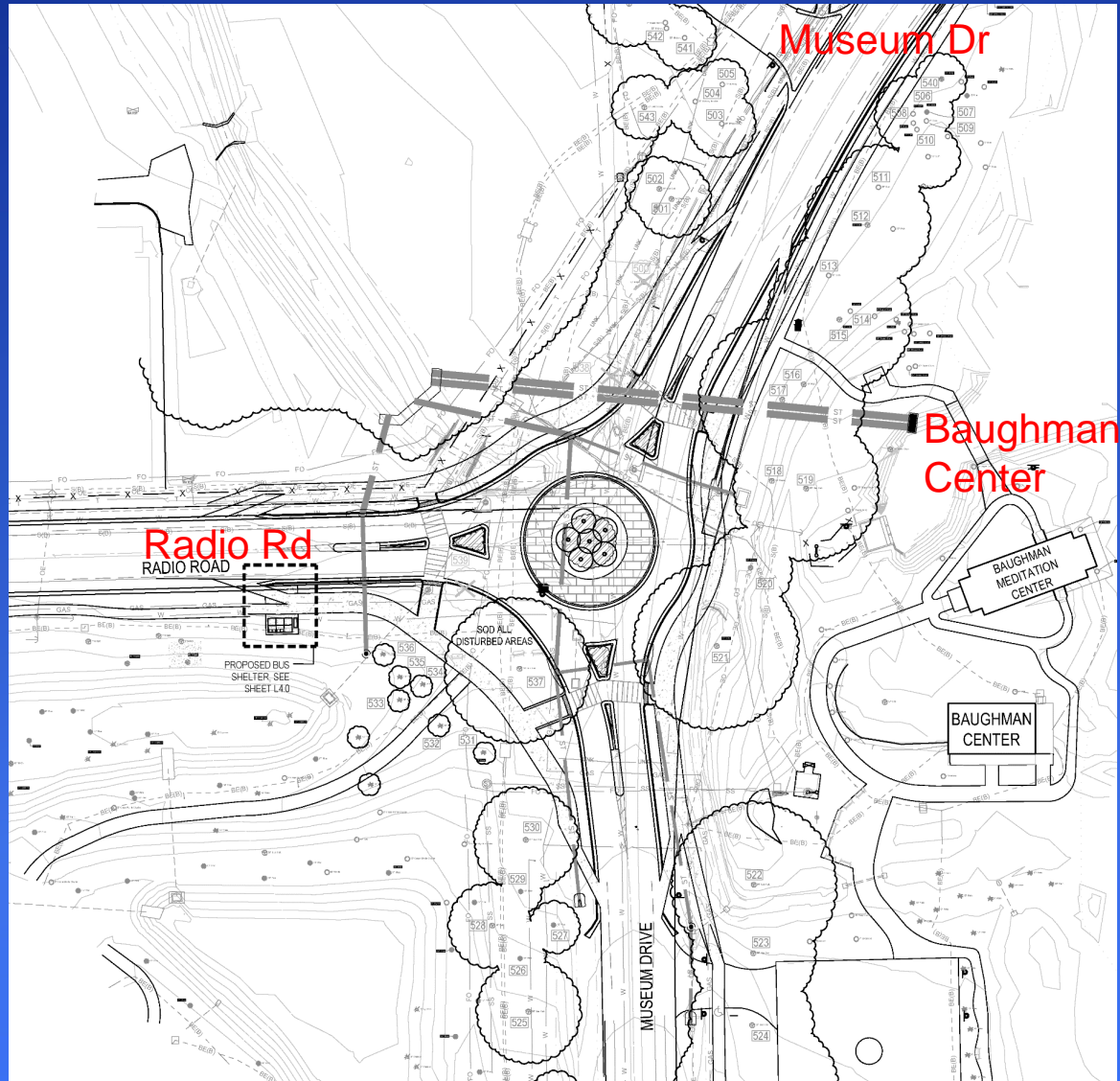

Proposed

SW Campus Transportation Improvements

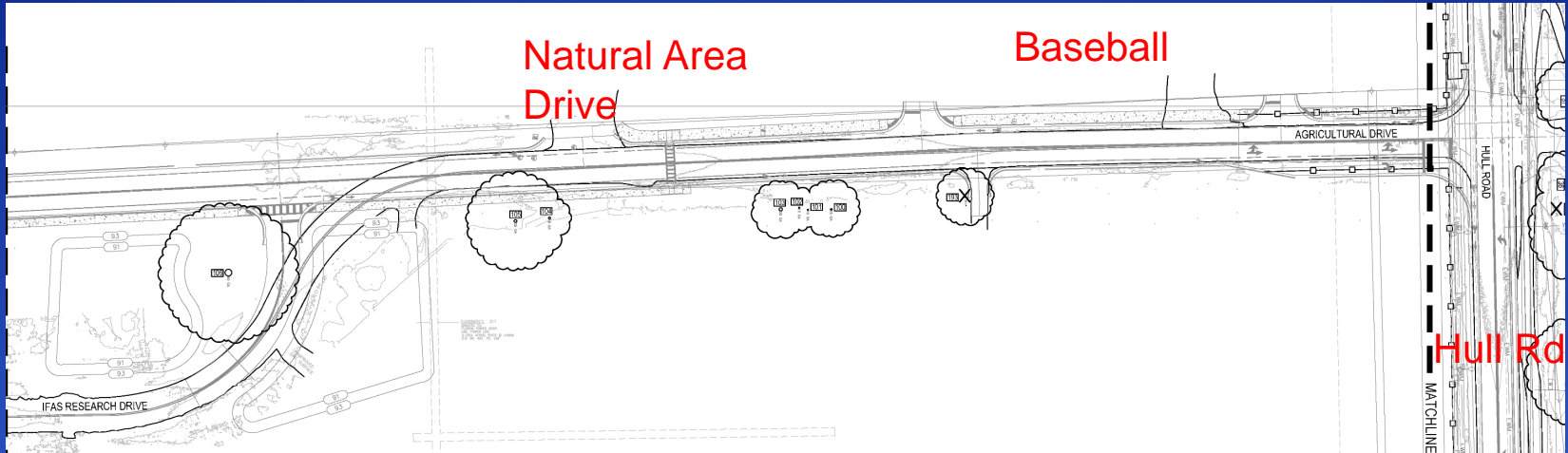

Impact

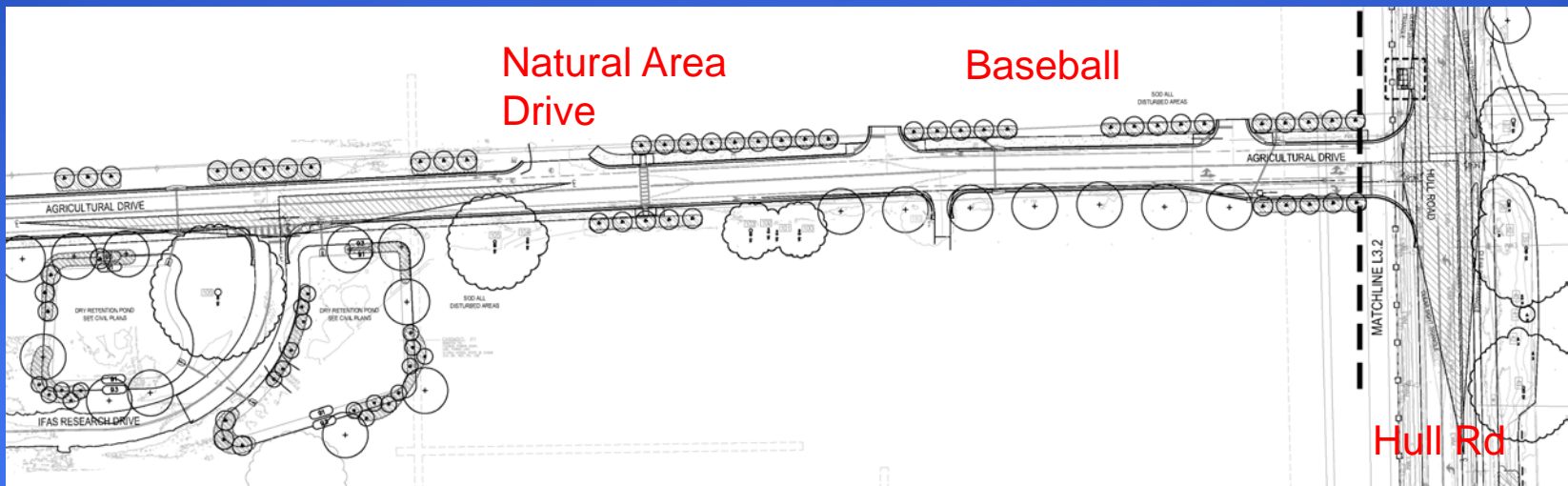

Proposed

SW Campus Transportation Improvements

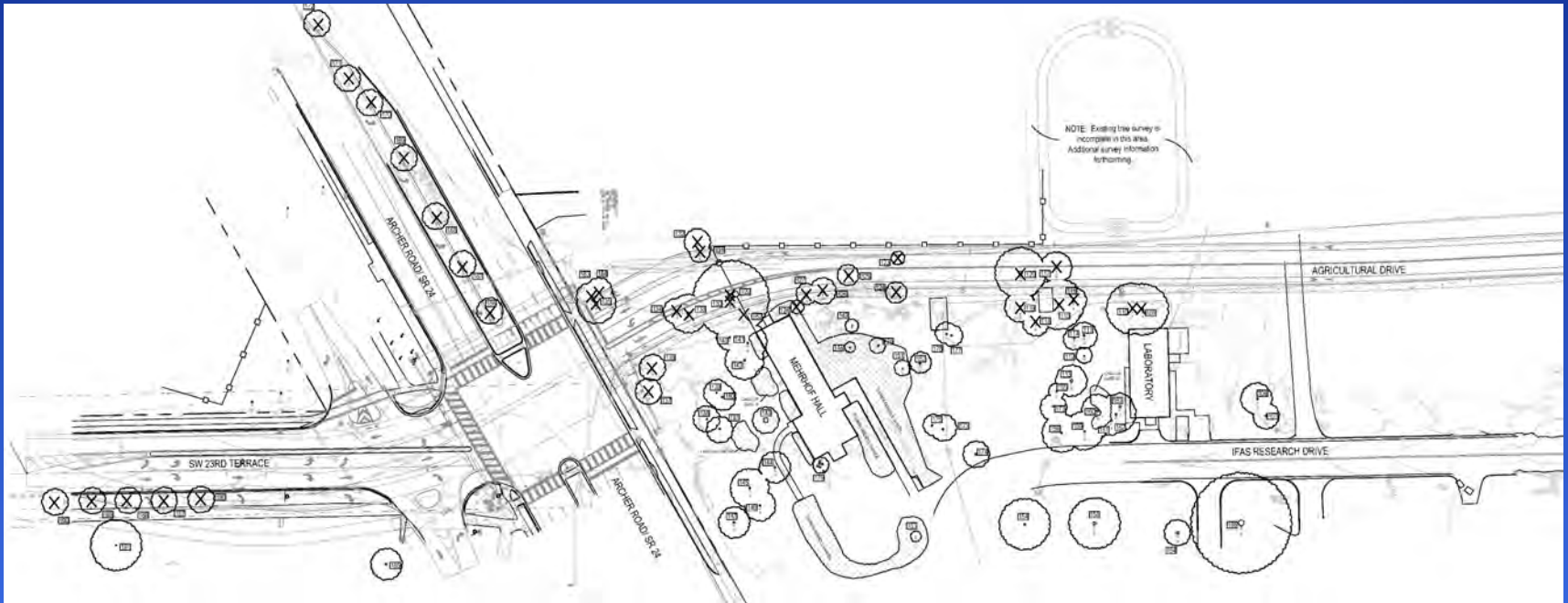

Impact

SW Campus Transportation Improvements

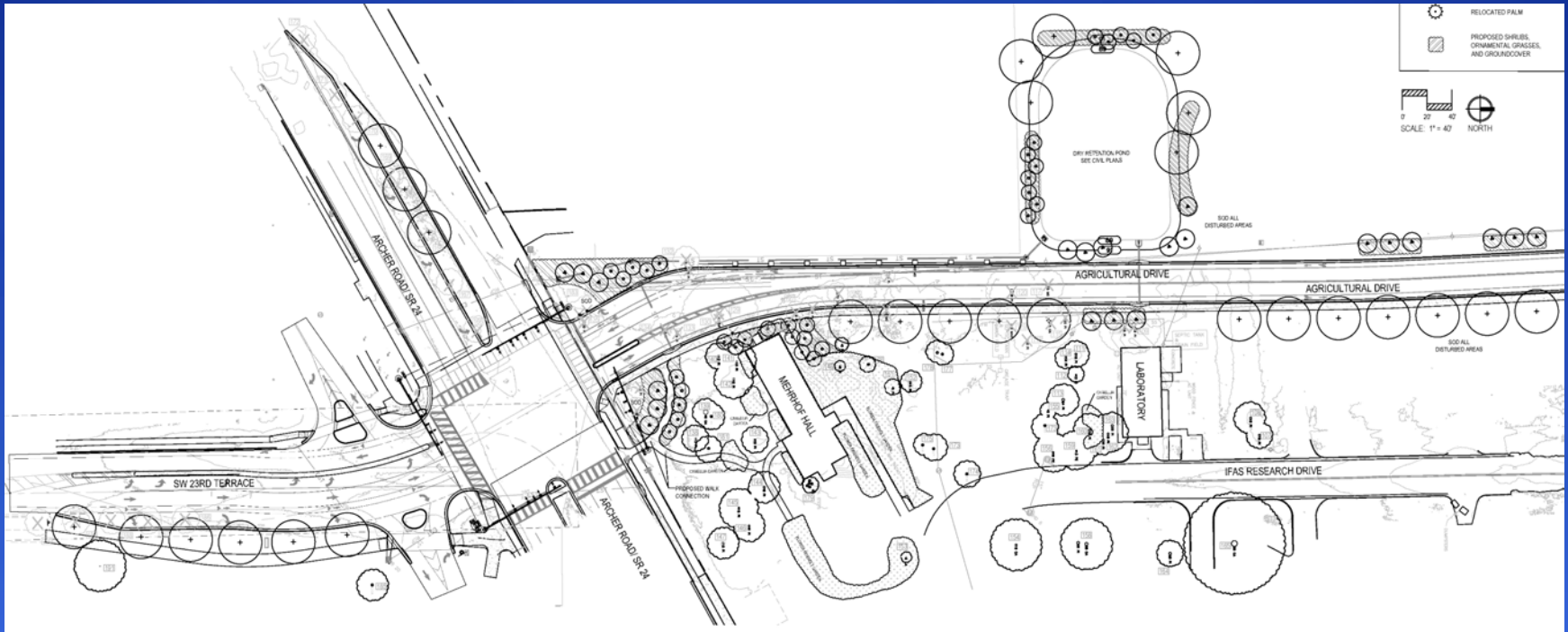

Proposed

SW Campus Transportation Improvements



SW Campus Transportation Improvements

EXISTING TREE INVENTORY AND MITIGATION CHART

HULL ROAD										
Tree No.	Scientific Name	Common Name	DBH	Rating	Remove	Remain	Mitigation	Replacement Trees	Notes	
1	Quercus virginiana	Live Oak	14	3	X		2:1	2		
2	Quercus virginiana	Live Oak	14	3	X		2:1	2		
3	Quercus virginiana	Live Oak	14	3	X		2:1	2		
4	Quercus virginiana	Live Oak	12	4	X		2:1	2		
5	Quercus virginiana	Live Oak	19	4	X		2:1	2		
6	Quercus virginiana	Live Oak	10	3	X		2:1	2		
7	Quercus virginiana	Live Oak	10	3	X		2:1	2		
8	Quercus virginiana	Live Oak	18	4		X				
9	Quercus virginiana	Live Oak	18	3		X				
10	Quercus virginiana	Live Oak	24	3		X				
11	Pinus spp.	Pine	12	3		X				
12	Pinus spp.	Pine	8	3		X				
13	Pinus spp.	Pine	19	3		X				
14	Pinus spp.	Pine	6	3		X				
15	Pinus spp.	Pine	8	3		X				
16	Pinus spp.	Pine	8	3		X				
17	Pinus spp.	Pine	9	3		X				
18	Pinus spp.	Pine	30	3	X		2:1	2		
19	Sabal palmetto	Sabal Palm	10	5	X		relocate		Relocate in vicinity - See Sht. L3.1	
20	Sabal palmetto	Sabal Palm	10	5		X				
21	Sabal palmetto	Sabal Palm	10	5	X		relocate		Relocate in vicinity - See Sht. L3.1	
22	Sabal palmetto	Sabal Palm	10	5		X				
23	Sabal palmetto	Sabal Palm	10	5	X		relocate		Relocate in vicinity - See Sht. L3.1	
24	Quercus virginiana	Live Oak	32	3	X		2:1+6	8		
25	Sabal palmetto	Sabal Palm	10	5		X				
26	Sabal palmetto	Sabal Palm	19	5	X					
27	Sabal palmetto	Sabal Palm	10	5	X		relocate		Relocate in vicinity - See Sht. L3.1	
28	Sabal palmetto	Sabal Palm	10	5		X				
29	Sabal palmetto	Sabal Palm	10	5		X				
30	Quercus virginiana	Live Oak	28	3		X				
31	Sabal palmetto	Sabal Palm	10	5		X				
32	Sabal palmetto	Sabal Palm	10	5		X				
33	Sabal palmetto	Sabal Palm	10	5		X				
34	Quercus virginiana	Live Oak	32	4		X				
35	Sabal palmetto	Sabal Palm	10	5		X				
36	Quercus virginiana	Live Oak	32	3		X				
37	Quercus virginiana	Live Oak	43	4		X				
38	Quercus virginiana	Live Oak	39	4		X				
39	Quercus virginiana	Live Oak	25	4		X				
40	Quercus virginiana	Live Oak	46	5		X				
41	Pinus spp.	Pine	10	3		X				
42	Pinus spp.	Pine	6	3		X				
43	Pinus spp.	Pine	6	3		X				
44	Pinus spp.	Pine	24	4		X				
45	Pinus spp.	Pine	23	4		X				
46	Pinus spp.	Pine	12	3		X				
47	Pinus spp.	Pine	19	4		X				
48	Quercus virginiana	Live Oak	52	5	X		2:1+56	18		
49	Pinus spp.	Pine	6	4		X				
50	Pinus spp.	Pine	26	4		X				
51	Pinus spp.	Pine	9	4		X				
52	Pinus spp.	Pine	20	3		X				
53	Pinus spp.	Pine	40	4		X				
54	Pinus spp.	Pine	26	4		X				
55	Pinus spp.	Pine	21	4		X				
56	Pinus spp.	Pine	21	4		X				
57	Pinus spp.	Pine	21	4		X				
58	Pinus spp.	Pine	21	4		X				
59	Bursera copallata	Pinudo Palm	12	4		X	2:1	2		
60	Sabal palmetto	Sabal Palm	8	4		X				
61	Sabal palmetto	Sabal Palm	12	4		X				
62	Pine spp.	Pine	9	3	X		2:1	2		
HULL ROAD TOTAL MITIGATION:								46		

AGRICULTURAL ROAD

Tree No.	Scientific Name	Common Name	DBH	Rating	Remove	Remain	Mitigation	Replacement Trees	Notes	
100	Quercus virginiana	Live Oak	3	3		X				
101	Pinus serotina	White Cherry	10	1		X				
102	Quercus nigra	Water Oak	12	3		X				
103	Quercus laevis	Laurel Oak	18	3		X				
104	Quercus virginiana	Live Oak	18	3		X				
105	Quercus virginiana	Live Oak	25	3		X				
106	Quercus virginiana	Live Oak	50	5		X				
107	Pinus spp.	Pine	18	2		X				
108	Pinus spp.	Pine	18	3		X				
109	Pinus spp.	Pine	100	4	X		2:1	2		
110	Pinus spp.	Pine	25	3	X		2:1	2		
111	Pinus spp.	Pine	18	3		X				
112	Pinus spp.	Pine	22	3		X				
113	Pinus spp.	Pine	24	4		X				
114	Pinus spp.	Pine	19	3		X				
115	Quercus nigra	Water Oak	17	18	4	X	2:1	2		
116	Pinus spp.	Pine	18	3		X	2:1	2		
117	Magnolia grandiflora	Southern Magnolia	15	3		X	2:1	2		
118	Pinus spp.	Pine	18	2		X	2:1	2		
119	Magnolia grandiflora	Southern Magnolia	15	3		X	2:1	2		
120	Pinus spp.	Pine	29	5	X		2:1	2		
121	Not Used									
122	Not Used									
123	Sabal palmetto	Sabal Palm	12	3		X	2:1	2		
124	Sabal palmetto	Sabal Palm	25	4		X	2:1	2		
125	Pinus spp.	Pine	23	4		X	2:1	2		
126	Pinus spp.	Pine	18	2		X	2:1	2		
127	Pinus spp.	Pine	18	3		X	2:1	2		
128	Pinus spp.	Pine	10	3		X	2:1	2		
129	Quercus virginiana	Live Oak	32	4		X	2:1+6	8		
130	Pinus spp.	Pine	22	3		X	2:1	2		
131	Pinus spp.	Pine	35	3		X	2:1	2		
132	Quercus laevis	Laurel Oak	19	3		X	2:1	2		
133	Pinus spp.	Pine	25	3		X	2:1	2		
134	Pinus spp.	Pine	14	2		X	2:1	2		
135	Pinus spp.	Pine	29	5		X	2:1	2		
136	Pinus spp.	Pine	10	1		X	2:1	2		
137	Pinus spp.	Pine	15	3		X	2:1	2		
138	Pinus spp.	Pine	15	2		X				
139	Pinus spp.	Pine	21	3		X				
140	Pinus spp.	Pine	13	3		X				
141	Pinus spp.	Pine	15	3		X				
142	Pinus spp.	Pine	18	3		X				
143	Quercus virginiana	Live Oak	43	5		X				
144	Pinus spp.	Pine	18	3		X				
145	Pinus spp.	Pine	15	2		X				
146	Pinus spp.	Pine	15	2		X				
147	Pinus spp.	Pine	15	2		X				
148	Pinus spp.	Pine	8	3		X				
149	Pinus spp.	Pine	8	4		X				
150	Not Used									
151	Pinus spp.	Pine	22	4		X				
152	Pinus spp.	Pine	22	3		X				
153	Magnolia grandiflora	Southern Magnolia	6	3		X				
154	Pinus spp.	Pine	25	2		X				
155	Pinus spp.	Pine	26	3		X				
156	Carpe Bismarckii	Pecan	22	2		X				
157	Not Used									
158	Quercus virginiana	Live Oak	31	5		X				
159	Carpe Bismarckii	Pecan	13	3		X				
160	Pinus spp.	Pine	18	3		X				
161	Pinus spp.	Pine	18	3		X				
162	Pinus spp.	Pine	18	3		X				
163	Pinus spp.	Pine	22	4		X				
164	Pinus spp.	Pine	25	4		X				
165	Quercus virginiana	Live Oak	55	4		X				
166	Quercus virginiana	Live Oak	18	3	X		2:1	2	In FOOT Right of Way	
167	Quercus virginiana	Live Oak	18	3	X		2:1	2	In FOOT Right of Way	
168	Quercus virginiana	Live Oak	3	5	X		2:1	2	In FOOT Right of Way	
169	Quercus virginiana	Live Oak	6	5	X		2:1	2	In FOOT Right of Way	
170	Quercus virginiana	Live Oak	6	5	X		2:1	2	In FOOT Right of Way	
171	Quercus virginiana	Live Oak	6	5	X		2:1	2	In FOOT Right of Way	
172	Quercus virginiana	Live Oak	6	5	X		2:1	2	In FOOT Right of Way	
173	Pinus spp.	Pine	32	4		X				
174	Pinus spp.	Pine	25	4		X				
175	Pinus spp.	Pine	28	3		X				
176	Jambos calycata	Southern Red Cedar	10	4		X				
177	Pinus spp.	Pine	11	4		X				
178	Pinus spp.	Pine	9	4		X				
179	Sabal palmetto	Sabal Palm Cluster	12	4		X				
180	Pinus spp.	Pine	11	3		X				

AGRICULTURAL ROAD, con't

Tree No.	Scientific Name	Common Name	DBH	Rating	Remove	Remain	Mitigation	Replacement Trees	Notes	
181	Pinus spp.	Pine	18	3		X				
182	Pinus spp.	Pine	22	3		X				
183	Quercus laevis	Laurel Oak	10	2	X		2:1	2		
184	Quercus laevis	Laurel Oak	14	3		X				
185	Quercus laevis	Laurel Oak	22	2		X				
186	Quercus virginiana	Live Oak	14	3	X		2:1	2	In City of Gainesville Right of Way	
187	Quercus virginiana	Live Oak	14	3	X		2:1	2	In City of Gainesville Right of Way	
188	Quercus virginiana	Live Oak	14	3	X		2:1	2	In City of Gainesville Right of Way	
189	Quercus virginiana	Live Oak	14	3	X		2:1	2	In City of Gainesville Right of Way	
190	Quercus virginiana	Live Oak	18	3	X		2:1	2	In City of Gainesville Right of Way	
191	Quercus virginiana	Live Oak	25	5		X				
192	Quercus virginiana	Live Oak	15	4		X				
193	Quercus laevis	Laurel Oak	26	3		X	2:1	2	In City of Gainesville Right of Way	

NOTE: ADDITIONAL SURVEY IS REQUIRED FOR A PORTION OF THE AGRICULTURAL DRIVE PROJECT AREA IN THE AREA OF THE WESTERN PROJECT STORMWATER POND. THESE ADDITIONAL EXISTING TREES WILL BE INCLUDED AS UPDATED SURVEY INFORMATION IS RECEIVED.

MUSEUM DRIVE & RADIO ROAD

WISCONSIN DNR • BURNED PLOTS									
Tree No.	Scientific Name	Common Name	DBH	Rating	Remove	Remain	Mitigation	Replacement Trees	Notes
500	Acer rubrum	Red Maple	13	3	X		2:1	2	
501	Carya glabra	Pignut Hickory	24	3		X			
502	Quercus virginiana	Live Oak	26	3		X			
503	Liquidambar styraciflua	Sweet Gum	26	2		X			
504	Carya glabra	Pignut Hickory	11	7	4	X			
505	Carya glabra	Pignut Hickory	23	4		X			
506	Liquidambar styraciflua	Sweet Gum	17	2		X			
507	Pinus spp.	Pine	26	5		X			
508	Liquidambar styraciflua	Sweet Gum	9	2		X			
509	Liquidambar styraciflua	Sweet Gum	6	2		X			
510	Liquidambar styraciflua	Sweet Gum	7	2		X			
511	Quercus virginiana	Live Oak	30	3		X			
512	Quercus major	Water Oak	27	4		X			
513	Liquidambar styraciflua	Sweet Gum	16	3		X			
514	Liquidambar styraciflua	Sweet Gum	15	2		X			
515	Quercus bicolor	Lancet Oak	30	2		X			
516	Acer rubrum	Red Maple	15	2		X			
517	Quercus virginiana	Live Oak	46	4		X			
518	Acer rubrum	Red Maple	14	3		X			
519	Quercus virginiana	Live Oak	20	3		X			
520	Acer rubrum	Red Maple	29	3		X			
521	Quercus virginiana	Live Oak	67	4		X			
522	Quercus virginiana	Live Oak	26	4		X			
523	Quercus virginiana	Live Oak	26	4		X			
524	Quercus virginiana	Live Oak	28	3		X			
525	Quercus virginiana	Live Oak	26	4		X			
526	Pinus spp.	Pine	15	4		X			
527	Pinus spp.	Pine	18	3		X			
528	Quercus shumardii	Shumard Oak	15	4		X			
529	Pinus spp.	Pine	18	4		X			
530	Quercus virginiana	Live Oak	24	5		X			
531	Sabal palmetto	Sabal Palm	8	3		X			
532	Sabal palmetto	Sabal Palm	12	3		X			
533	Sabal palmetto	Sabal Palm	15	3		X			
534	Sabal palmetto	Sabal Palm	9	3		X			
535	Sabal palmetto	Sabal Palm	13	3		X			
536	Sabal palmetto	Sabal Palm	17	3		X			
537	Quercus virginiana	Live Oak	18	5		X			
538	Acer rubrum	Red Maple	36	3	X		2:1	2	
539	Quercus rubra	Red Oak	14	4		X			
540	Quercus alba	American Holly	11	3		X			
541	Carya glabra	Pignut Hickory	22	4		X			
542	Liquidambar styraciflua	Sweet Gum	22	2		X			
543	Liquidambar styraciflua	Sweet Gum	2	2		X			
544	Quercus virginiana	Live Oak	12	3		X			

SW Campus Transportation Improvements

Schedule

- Design
 - ASD – 10/2019
 - DD – 12/2019
 - CD – 4/2020
- Construction
 - Start – 7/2020
 - Finish – 2/2021



SW Campus Transportation Improvements

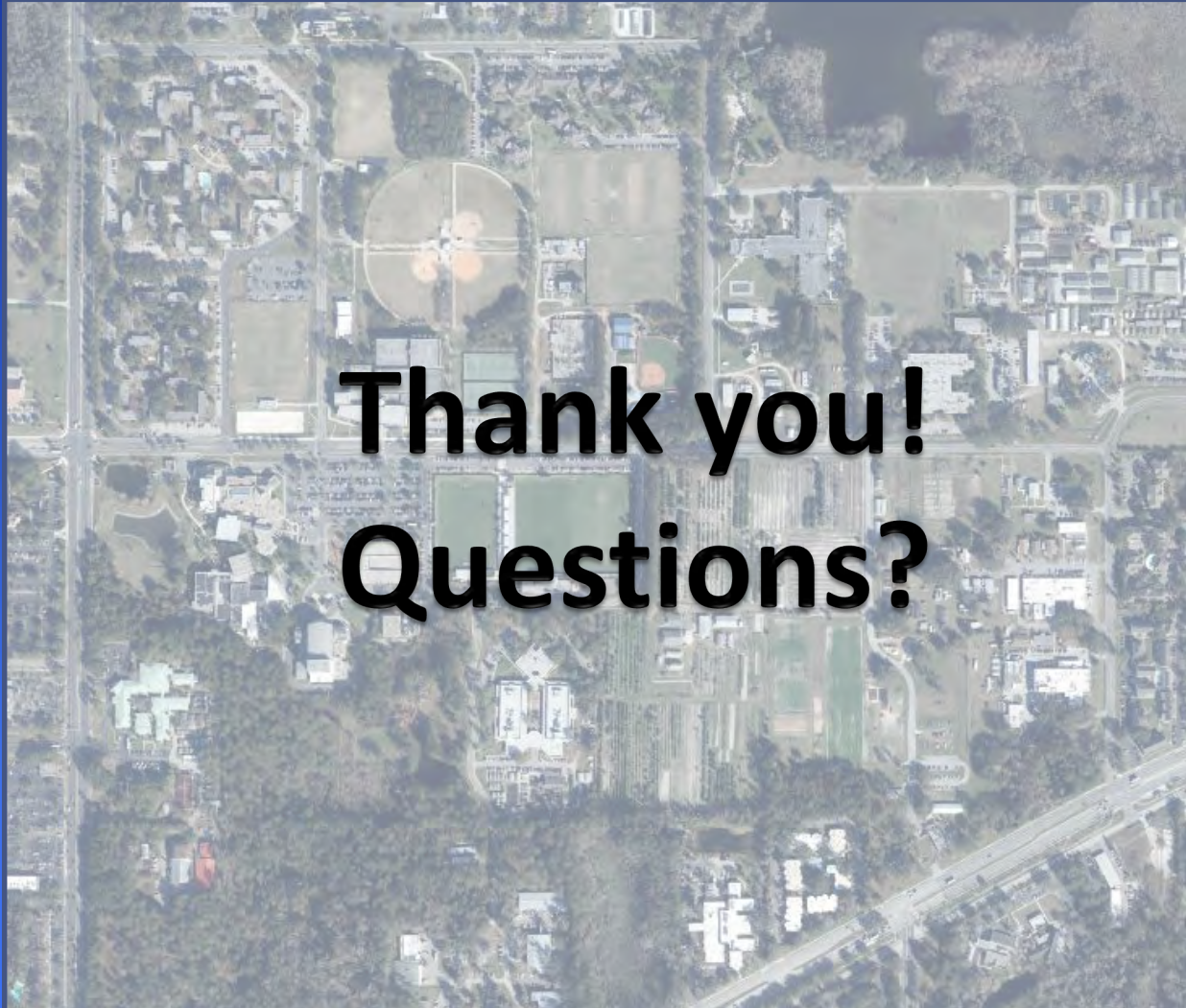

Thank you!
Questions?

UF | UNIVERSITY *of* FLORIDA





Location

THE HUB

BIKE
PARKING

MARSTON

Existing CSE/Marston Plaza Area

An aerial photograph of a campus, likely a university, showing a large central plaza area surrounded by buildings and trees. The plaza is a light-colored, open space that is the focus of the design criteria listed on the slide. The buildings are mostly rectangular and have dark roofs. There are many trees, particularly in the lower-left and upper-right areas of the image. A road or path runs along the right side of the plaza.

The MGC Monument must:

- Fit into the existing plaza area
- Accommodate up to 50 people
- Be an appropriate scale for its space
- Be highly visible

Design Criteria

THE HUB

MARSTON

CSE/Marston Plaza Area Modification



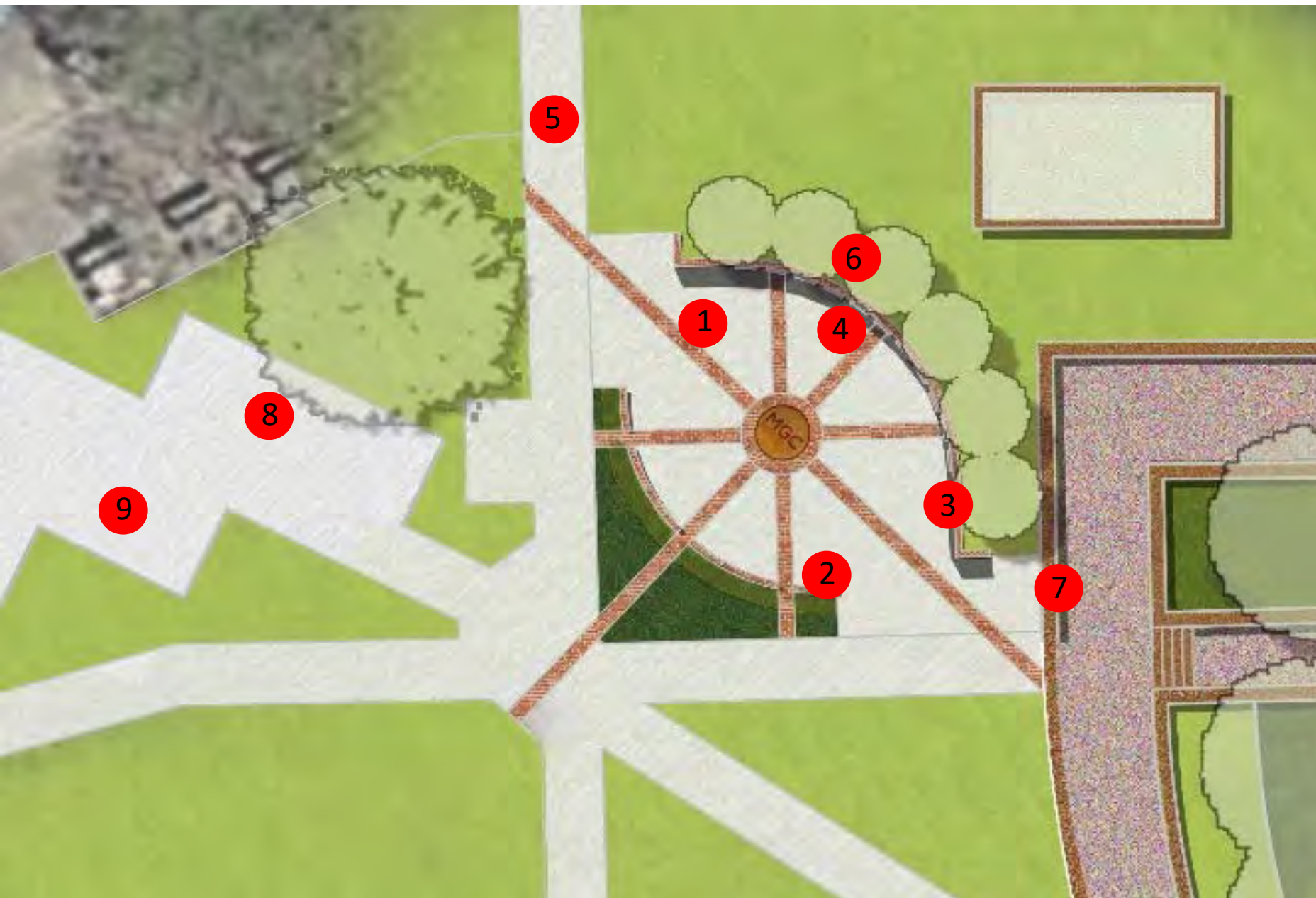

- 1 Brick Paving
- 2 Brick Seat Wall
- 3 Concrete Paving
- 4 MGC Monuments
- 5 Existing Paving
- 6 6' Brick Wall
- 7 Memorial Plaque
- 8 Proposed Bicycle Area
- 9 Existing Bicycle Area

Proposed Design



Proposed Design



Proposed Design



Proposed Design



**Sigma Lambda Beta
International Fraternity, Inc.**

Zeta Beta Chapter

**Founding Date:
April 4, 1986**

**Charter Date:
January 30, 1999**



**Lambda Theta Phi
Latin Fraternity, Inc.**

Phi Chapter

**Founding Date:
December 1, 1975**

**Charter Date:
March 5, 1995**



**Lambda Theta Alpha
Latin Sorority, Inc.**

Chi Chapter

**Founding Date:
December 1, 1975**

**Charter Date:
March 17, 1996**

Proposed Design



REITZ UNION SOUTH TERRACE RENOVATION

UF PROJECT NO: MP04860

UF BUILDING NO: 0686
UNIVERSITY OF FLORIDA
655 REITZ UNION DRIVE
GAINESVILLE, FLORIDA 32603



MP04860 REITZ UNION SOUTH TERRACE RENOVATION



PROJECT AERIAL

MP04860 REITZ UNION SOUTH TERRACE RENOVATION



MP04860 REITZ UNION SOUTH TERRACE RENOVATION



MP04860 REITZ UNION SOUTH TERRACE RENOVATION



MP04860 REITZ UNION SOUTH TERRACE RENOVATION

SOUTH TERRACE RENOVATION

CONCEPT DESIGN: DEFINING SCOPE

Objective:
Approval to move forward with construction documents and construction

THREE UMBRELLA CLUSTERS SHADE PORTIONS OF AMPHITHEATER THROUGHOUT THE DAY AND PROVIDE LIGHTING IN THE EVENINGS

BENCH SEATING BENEATH UMBRELLAS

FIVE NIGHT-LIT JUMPING JET FOUNTAINS MOUNTED AT BASE OF MEMORIAL PLAQUES, EACH DIRECTED AT MAIN FOUNTAIN

CURRENT MEMORIAL PLAQUES TO BE RELOCATED AT THE DISCRETION OF STUDENT VETERANS GROUP

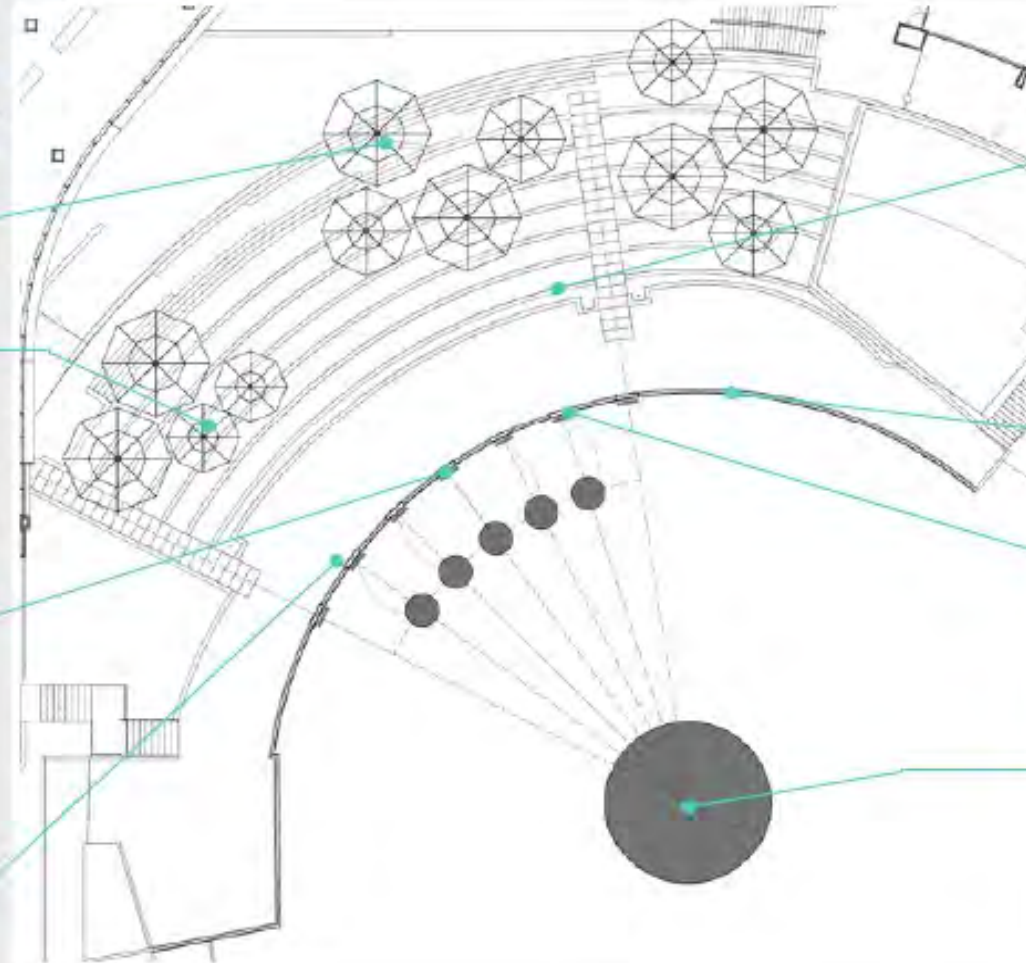

CURRENT AMPHITHEATER SEATING TO BE DEEP-CLEANED AND RE-SEALED

LIBERTY POND RAILING TO BE REPLACED WITH CABLE RAILING AS COMPONENT OF THE MEMORIAL FOR FALLEN GATORS

SEVEN ETCHED-GLASS, NIGHT-LIT MEMORIAL PLAQUES

NEW, LARGE FOUNTAIN FUNCTIONS AS MEMORIAL CENTER-PIECE



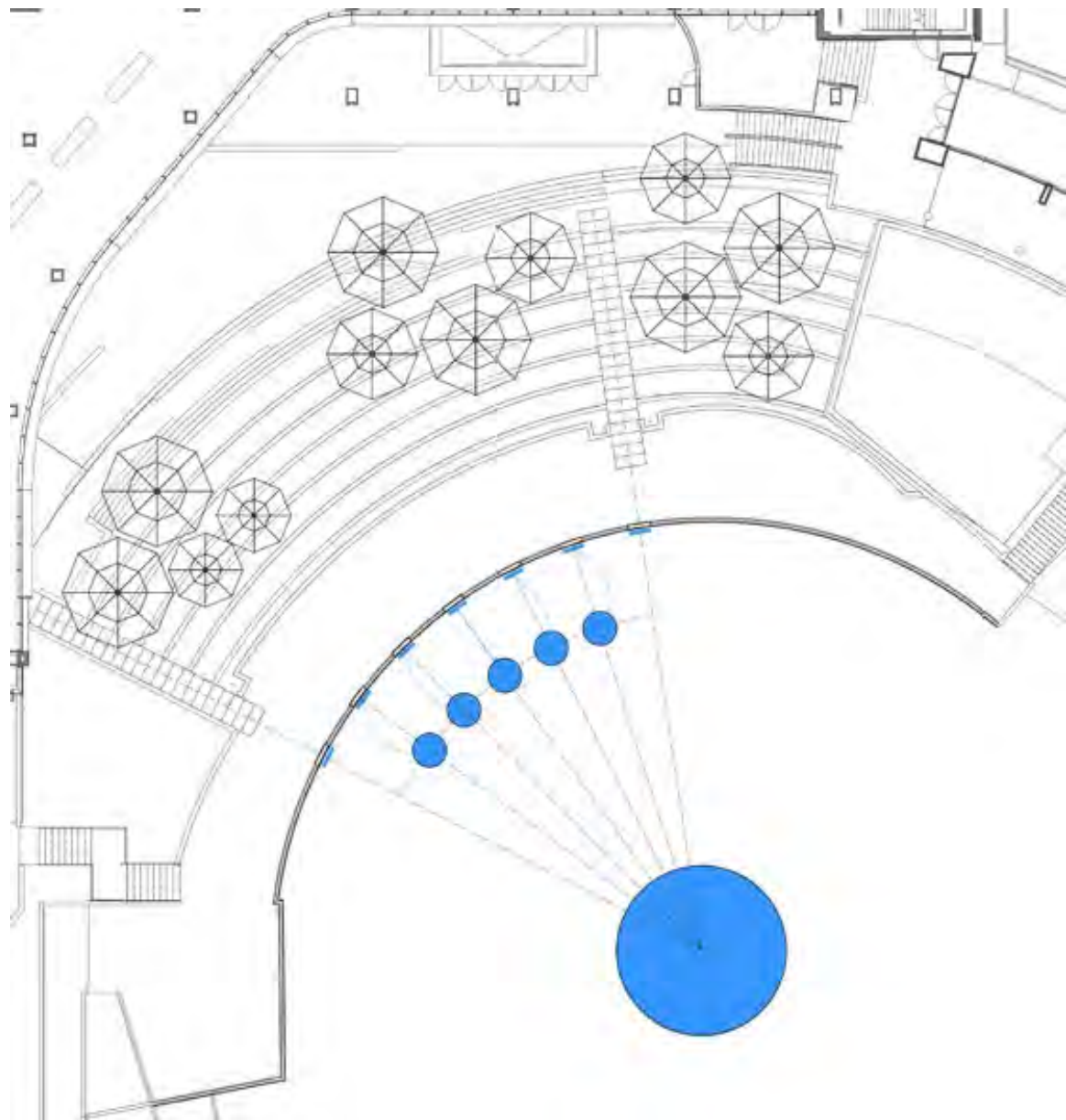



MP04860 REITZ UNION SOUTH TERRACE RENOVATION



MP04860 REITZ UNION SOUTH TERRACE RENOVATION



MP04860 REITZ UNION SOUTH TERRACE RENOVATION



MP04860 REITZ UNION SOUTH TERRACE RENOVATION

QUESTIONS ?

An aerial photograph of a university campus. In the foreground, there are several large, multi-story brick buildings with modern architectural features, including large glass windows. A prominent white, dome-shaped structure is visible on the left side. In the middle ground, a large stadium with a red roof and blue seating is visible. The campus is surrounded by dense green trees and vegetation. In the background, a large body of water is visible under a hazy sky. The text "Campus Master Plan" is overlaid in a large, black, sans-serif font, and "Update 2020-2030" is overlaid in a smaller, black, sans-serif font below it.

Campus Master Plan

Update 2020-2030

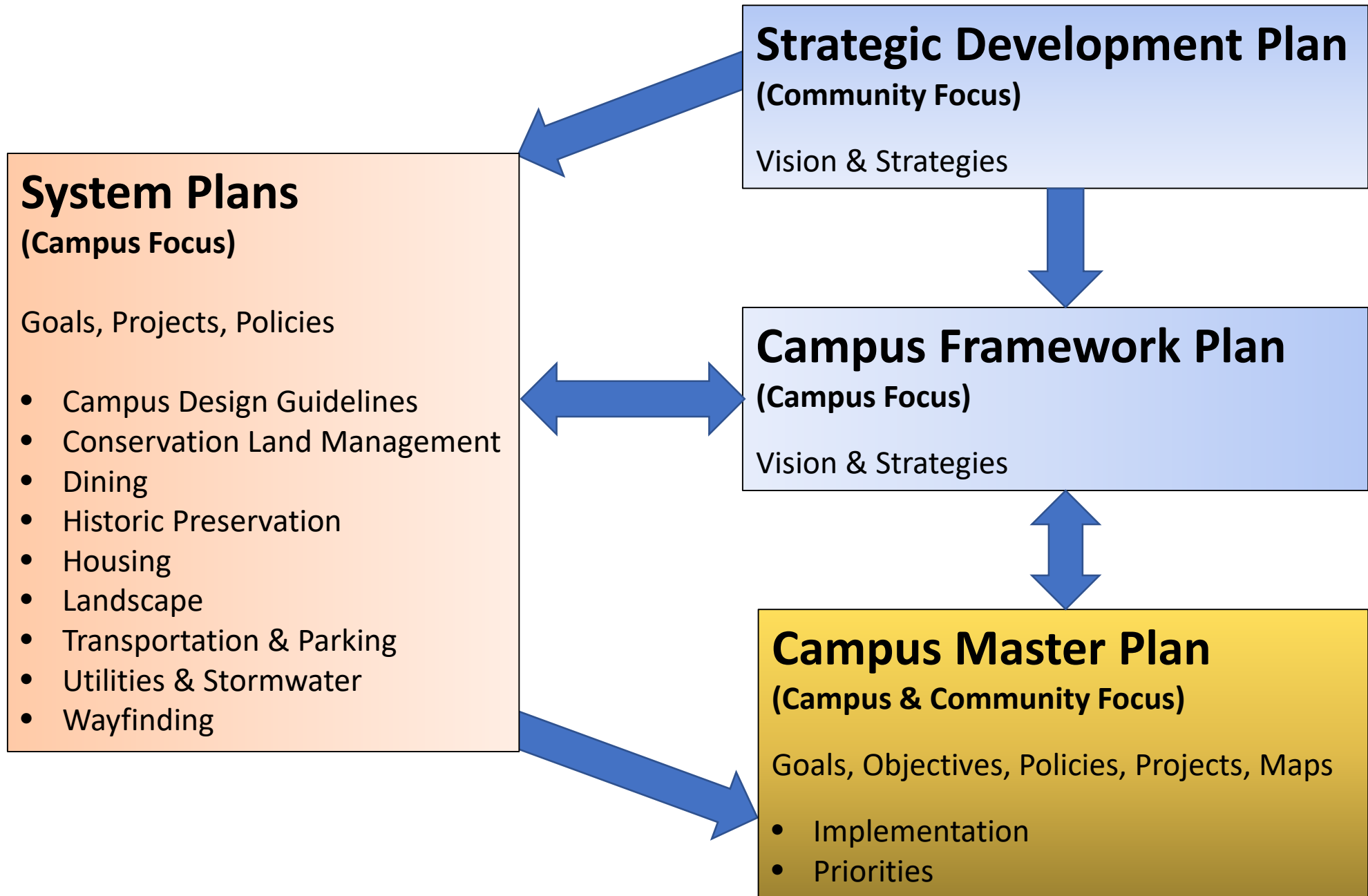

Process

- Florida Statutes, Chapter 1013.30
- FBOG Regulations, Chapter 21
- Campus Development Agreement, expires Dec. 31, 2020

What is the Campus Master Plan?

- Comparable to Local Government Comprehensive Plan
 - Aspects of Local Development Regulations
- Comparable to Developer Approval Process (DRI)
- Legal Status
- 10-Year Development Plan

Jurisdiction

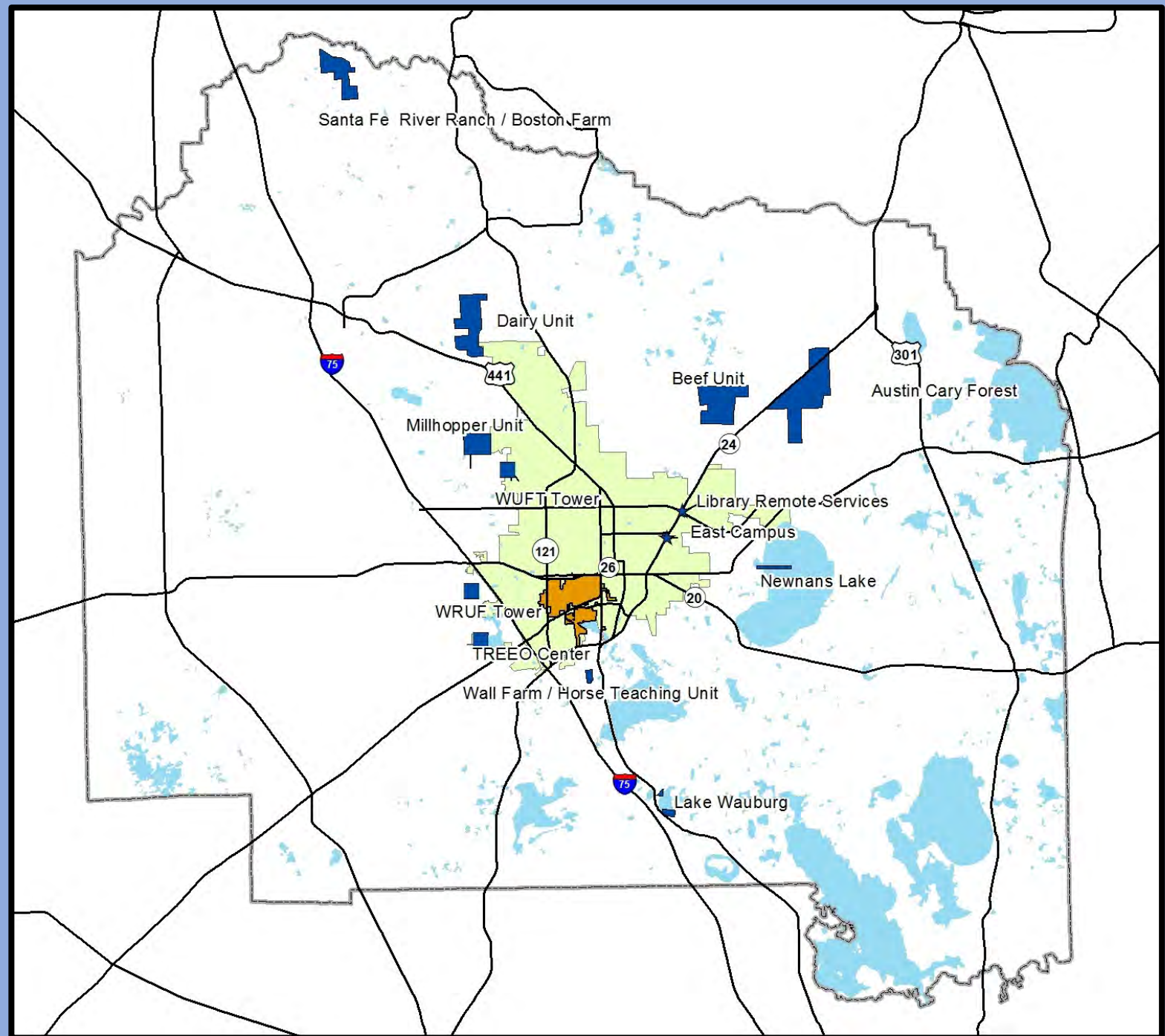

How is it used?

- **Communicate** with City, County and community
- Jurisdiction impacts **project review authority** and process
- **Future building site** decisions
- **State review** of debt financing and PECO submissions
- Policies affecting day-to-day **decision-making** and **operations** regarding
 - facilities
 - grounds
 - shared governance
 - intergovernmental coordination

Campus Development Agreement

- Expires December 31, 2020
- \$34.8m since 1998
- CDA 2006 provided impact mitigation of \$21.1m
 - \$3.8m Countywide Transportation Management System
 - \$4.8m RTS Transit Rolling Stock
 - \$1.0m to City and County for Bicycle/Pedestrian Facilities
 - \$1.6m to County for SW 8th Avenue
 - \$900,000 to City for SW 2nd Avenue
 - \$8.1m for Archer Rd/SW 16th Avenue
 - \$800,000 to City for Emergency Capital Equipment
- CDA 2004 provided \$3.5m continuing funds for RTS
- CDA 1998 provided \$10.2m for roads, transit & bike/ped

Schedule

- Summer 2019 – Begin
- December 6, 2019 – BOT Meeting, Introduction
- February 2020 – Required Public Information Session
- March 26, 2020 – BOT Meeting, Transmittal Public Hearing
- August 27, 2020 – BOT Retreat, Adoption Public Hearing
- December 3, 2020 – BOT Meeting, Campus Development Agreement Adoption

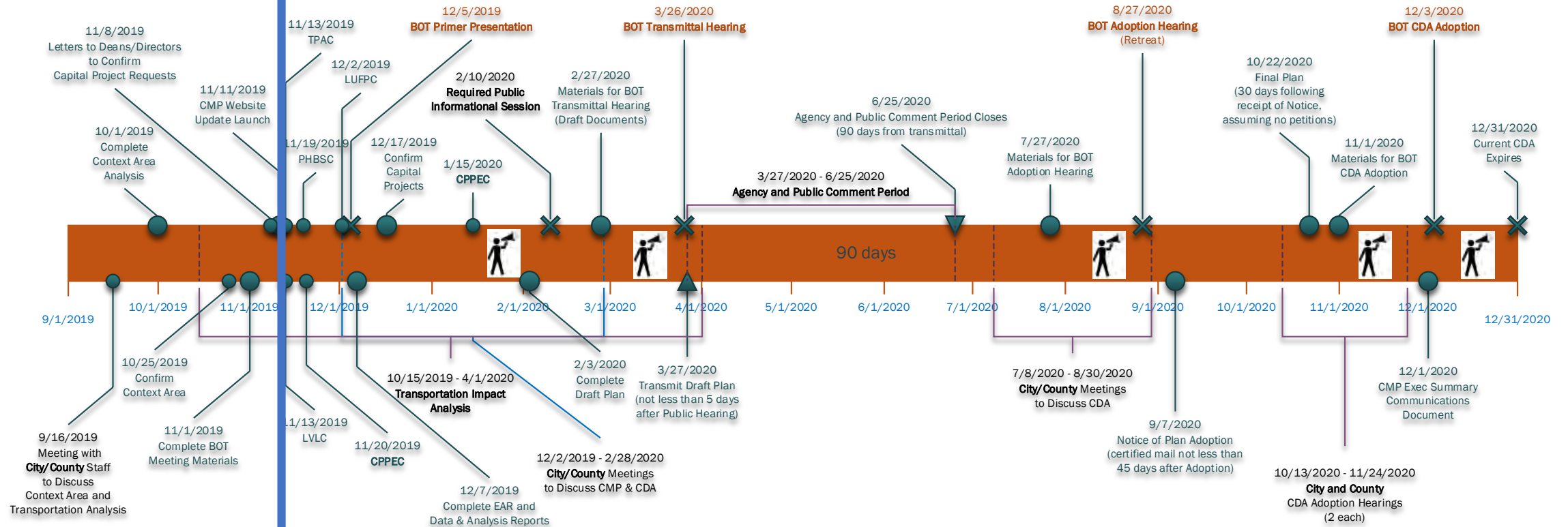

Recent Strategic Plans

Proximity

New
American City

Stewardship

Strong
Neighborhoods

Campus Framework Plan

Campus Districts

University West
Cultural plaza, health,
rec/athletic fields,
support

University Central
Residential, student life,
athletics

Lake Alice
Preserve

University East
RED BOX
Academics, research,
health, residential,
student life

University South
IFAS, Vet Med, health,
preserve

Five Themes

- Open Space & Infrastructure
- Interdisciplinary Research
- The Future of Learning
- Academic Regeneration
- The Student Experience

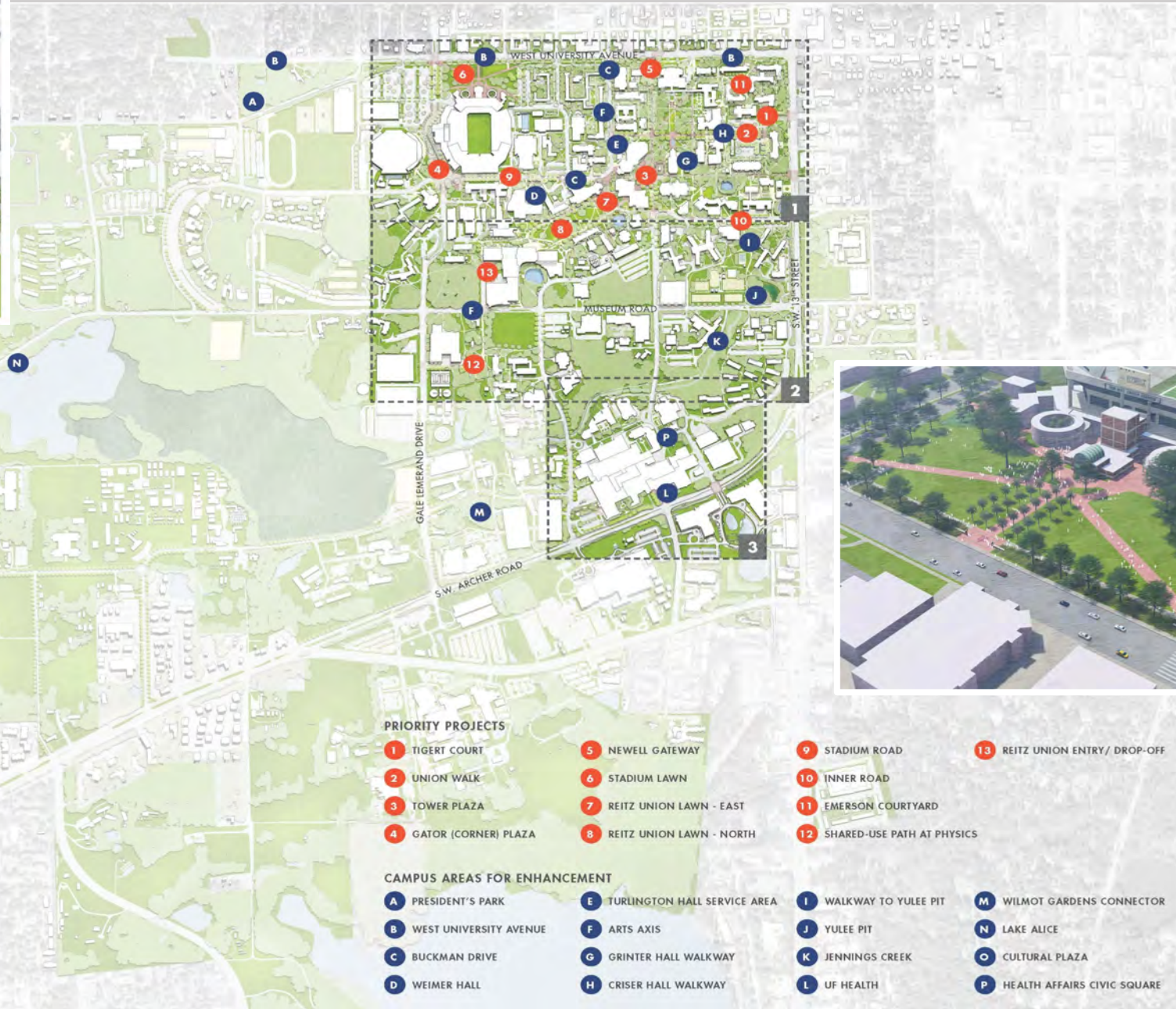



Housing Master Plan

Full Composite:

Open Space & Infrastructure
Interdisciplinary Research
The Future of Learning
The Student Experience
Academic Regeneration

■ Key Near Term Built Projects
■ Longer Term Built Projects

\$1.5B+ Capital Projects in Next Five Years

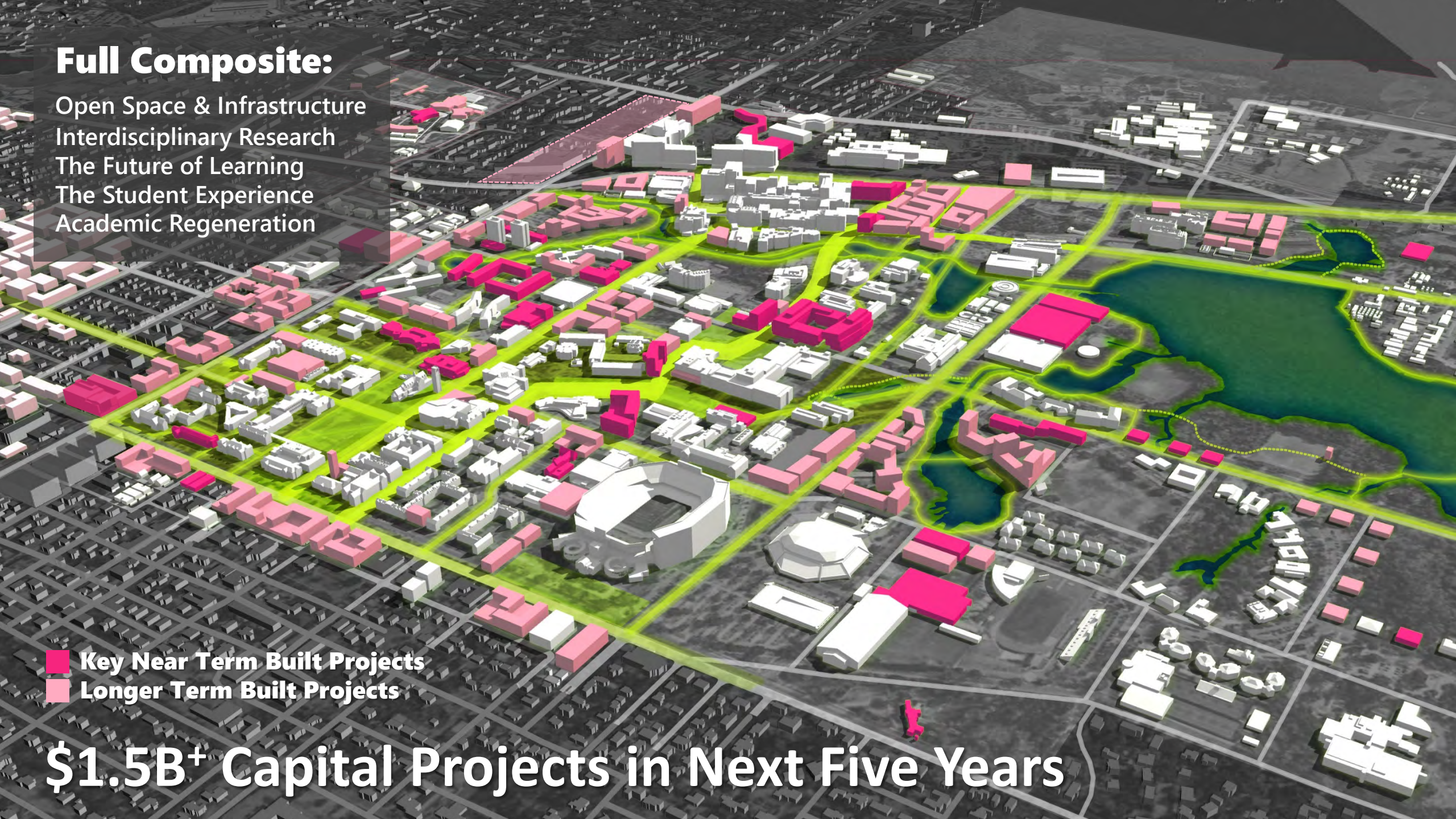

Future Land Use Map 2015 - 2025

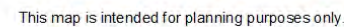

DRAFT

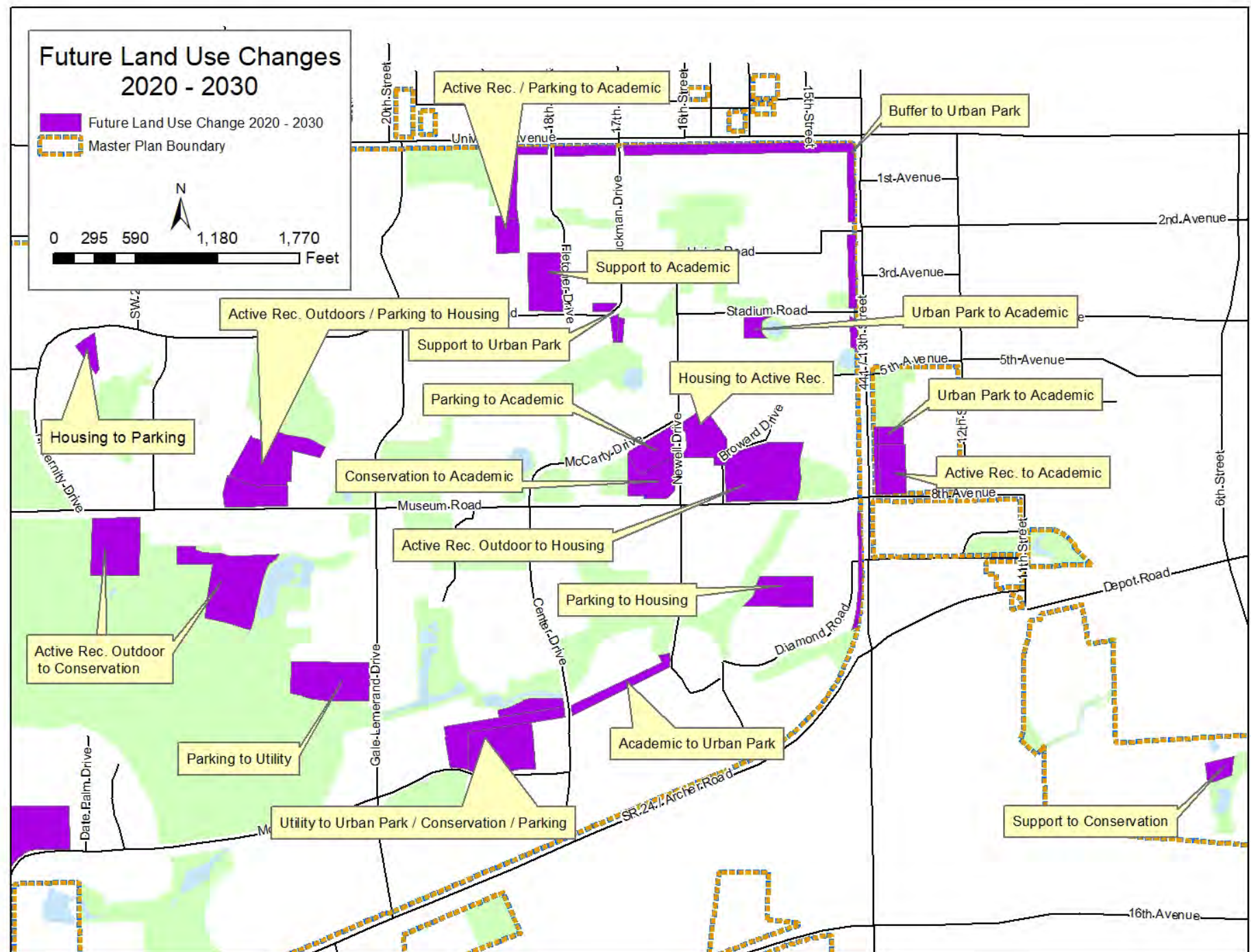

DRAFT

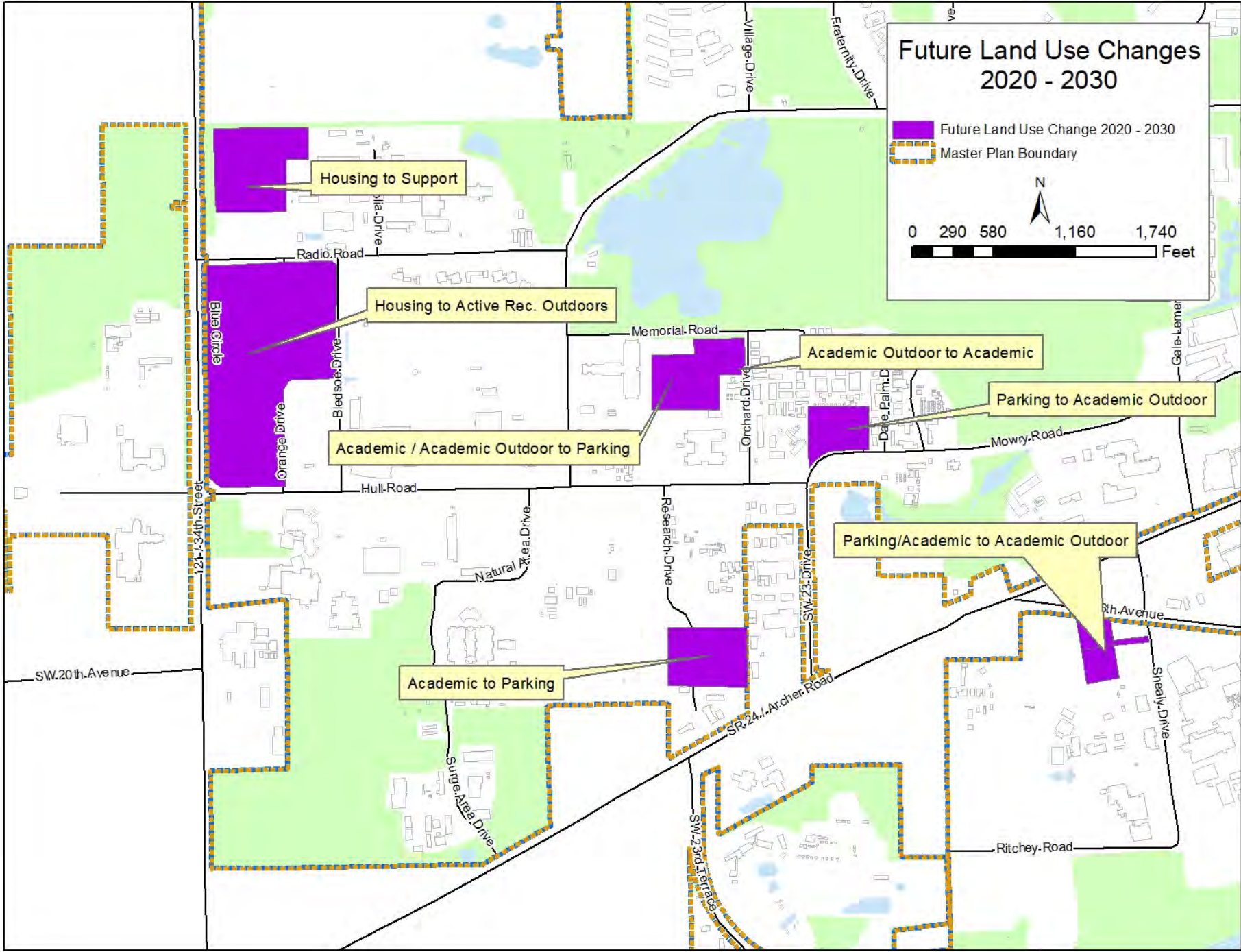

Questions?

[Masterplan.ufl.edu](https://masterplan.ufl.edu)

