

Site Visit #7: Lake Alice South & Solar Park

Thursday, April 21st, 2022 at 2:00pm

Meet-Up Location #1: Cancer Genetics Parking Lot



Meet-Up Location #2: Solar Park (West Side)



What to Bring:

- Water
- Sunscreen
- Insect Repellent
- Clipboard
- Pen/Pencil
- Raincoat or Poncho
- Shoes you don't mind getting wet

Contents for Review:

- Links to Current CALM plans
- iNaturalist Links
- Topographic Maps
- Wetlands Map
- Soils Map
- Archeology Map
- Guiding Questions

Contact Information:

Rachel Mandell – (352) 672-1836
Kaylee August – (918) 261-2773

Weather (as of 4/18/22):

Thu 21 | Day

80°



4%

ENE 13 mph

Mostly cloudy skies. High around 80F. Winds ENE at 10 to 15 mph.



Humidity
57%



UV Index
8 of 10



Sunrise
6:56 am



Sunset
8:00 pm

Where to Park:

- Orange Decal parking available in Cancer Genetics parking lot
- Blue Decal parking available in Archer Field parking lot
- Parking available near Solar Park / Carpool Option
- If you do not have a campus decal and need parking accommodations, please reach out to Rachel Mandell
- We encourage you to carpool, use public transit, or bike/walk!
- TAPS parking map: <https://taps.ufl.edu/parking-info/parking-map/>

Core Values:

- Committing to full participation
- Sharing collective wisdom for inclusive solutions
- Accepting shared responsibility
- Embracing creativity and a 'what if?' mindset
- Supporting open and equitable discussion
- **Have Fun!**

Links to Current CALM Plans:

[Lake Alice South](#)
[Solar Park](#)

iNaturalist Links:

[Lake Alice South](#)
[Solar Park](#)

Elevations Contours & Depressions

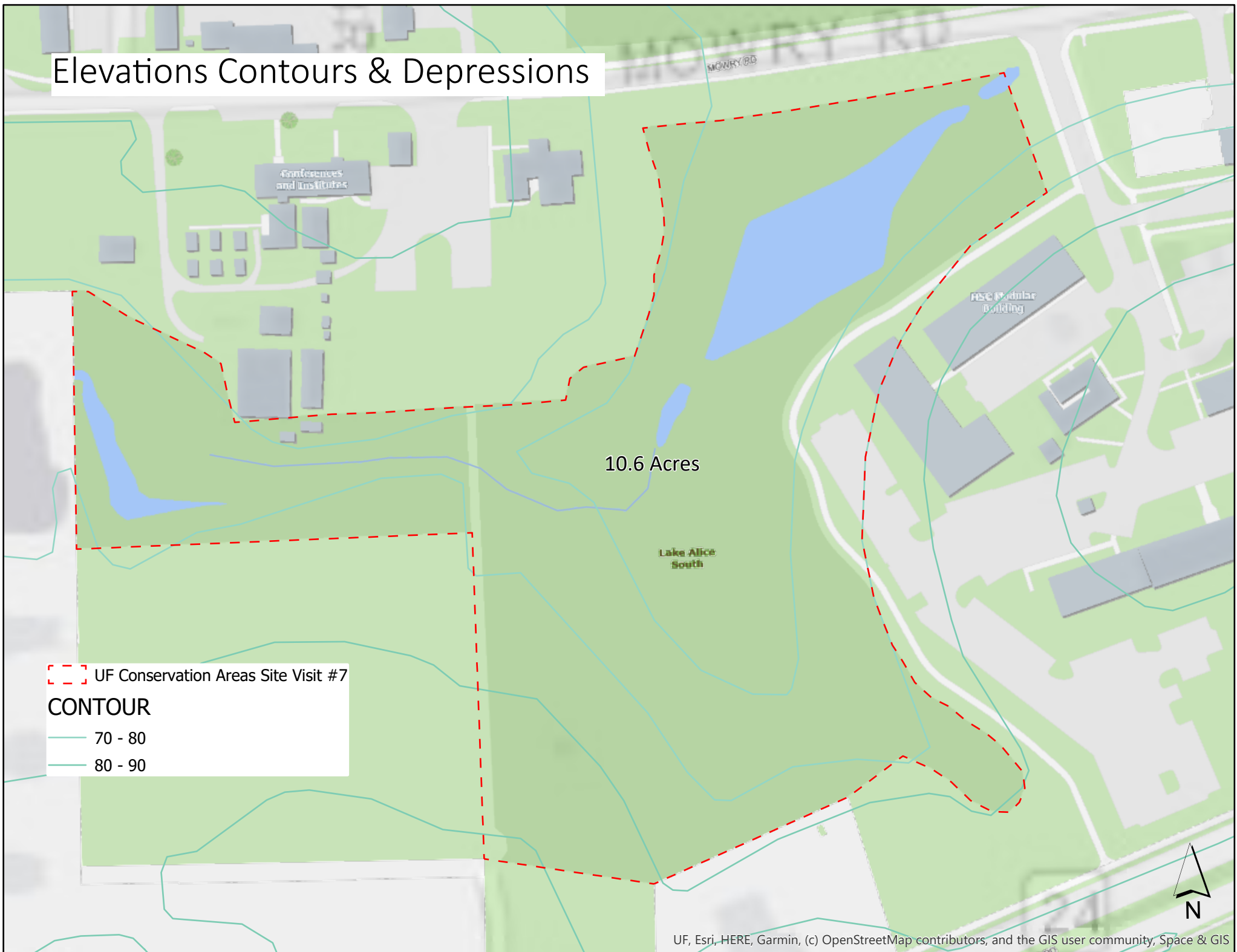

Wetlands



Soils

UF Conservation Areas Site Visit #7

Campus Soils

Type

- Arredondo
- Bivens
- Blichton
- Bonneau
- Kanapaha
- Lake Sand
- Lochloosa
- Surrency
- Water

10.6 Acres

Lake Alice South

BSC Modular Building

Archeology



Guiding Questions: Lake Alice South

Name: _____

Are there any obvious human interventions that impact the site negatively? Positively?

Is the conservation area accessible to all types of users (ex. Differently abled persons)?

How is this conservation area used and how could it be used in the future (nature walks, teaching, general exercise, mindfulness, etc.)?

How do the surrounding sites and uses potentially impact the conservation area?

Is this conservation area actively maintained? Should it be?

Are the boundaries of the conservation area clearly distinguishable?

Are there any new best management practices we should consider in this conservation area?

We encourage you to pause frequently and actively consider what your different senses are experiencing (hear, smell, see, feel). Describe them below:

Are there any additional observations/considerations we should be aware of for this conservation area (ex. Rare plant species)? Use this space to write down thoughts that may not fit within the other guiding questions.

Elevations Contours & Depressions



Wetlands



Soils

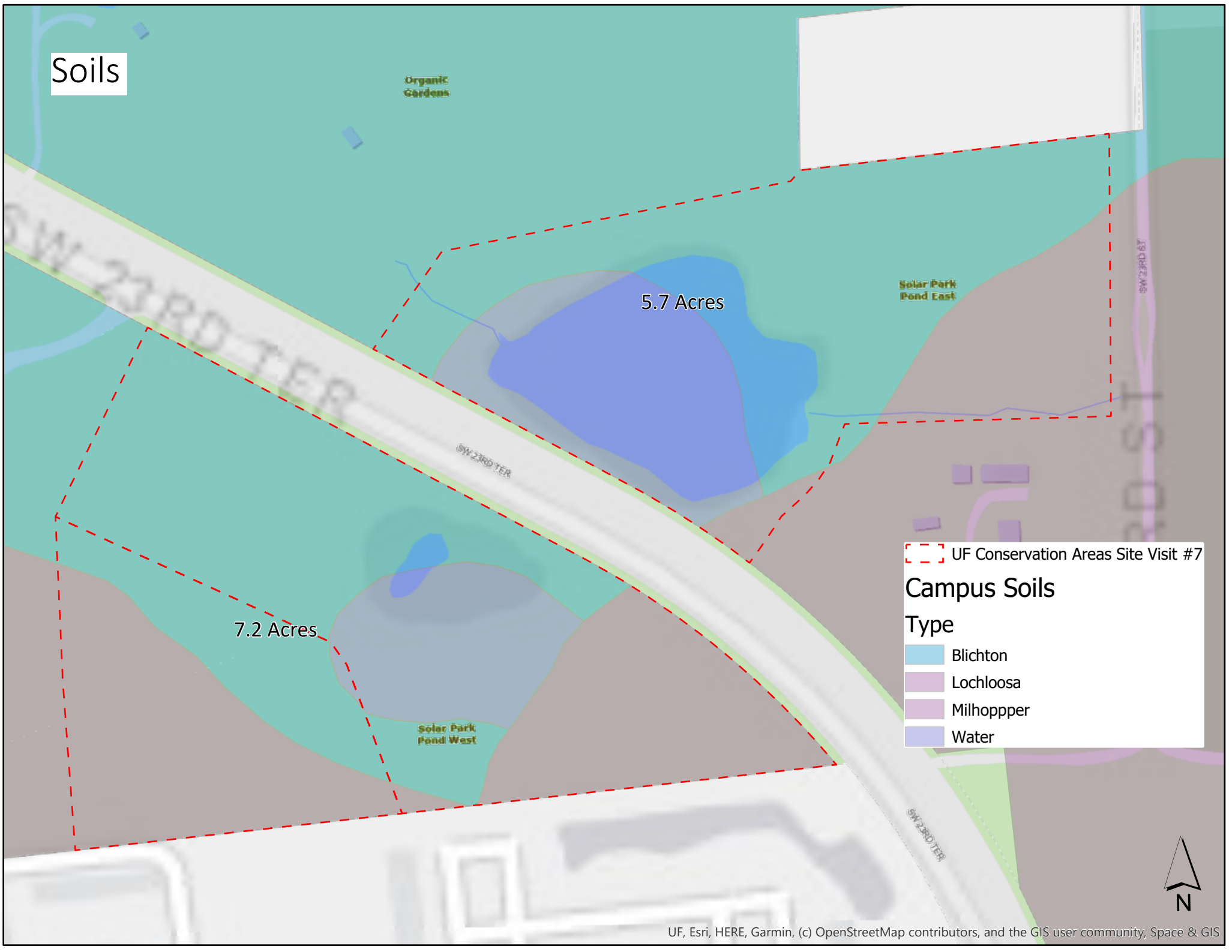

Archeology

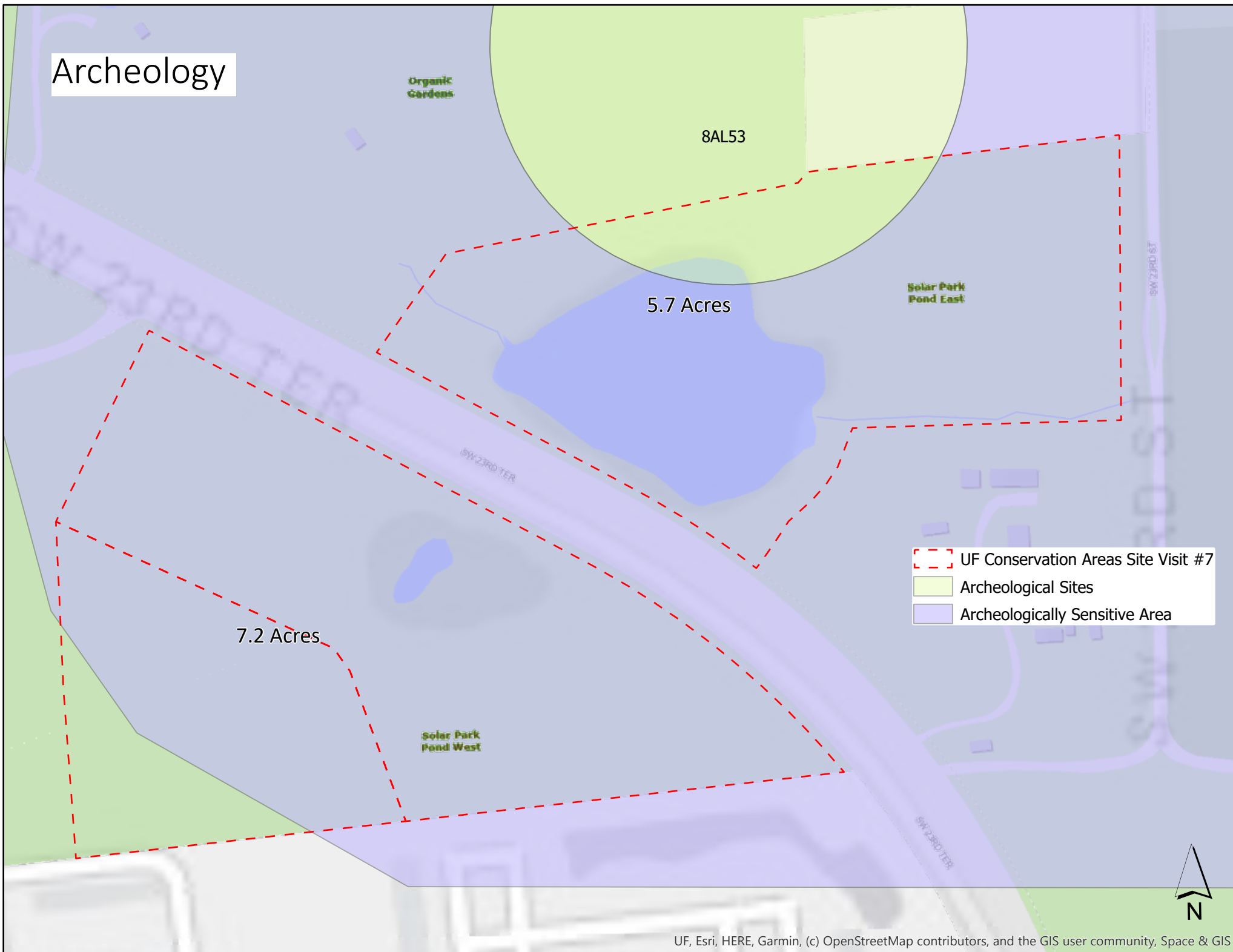

Guiding Questions: Solar Park

Name: _____

Are there any obvious human interventions that impact the site negatively? Positively?

Is the conservation area accessible to all types of users (ex. Differently abled persons)?

How is this conservation area used and how could it be used in the future (nature walks, teaching, general exercise, mindfulness, etc.)?

How do the surrounding sites and uses potentially impact the conservation area?

Is this conservation area actively maintained? Should it be?

Are the boundaries of the conservation area clearly distinguishable?

Are there any new best management practices we should consider in this conservation area?

We encourage you to pause frequently and actively consider what your different senses are experiencing (hear, smell, see, feel). Describe them below:

Are there any additional observations/considerations we should be aware of for this conservation area (ex. Rare plant species)? Use this space to write down thoughts that may not fit within the other guiding questions.